



Way Ahead:
**Regional Operations and
Communications Facility
("The ROC")**

August 18, 2022

Lines of Effort (LOE)

9-1-1 Consolidation

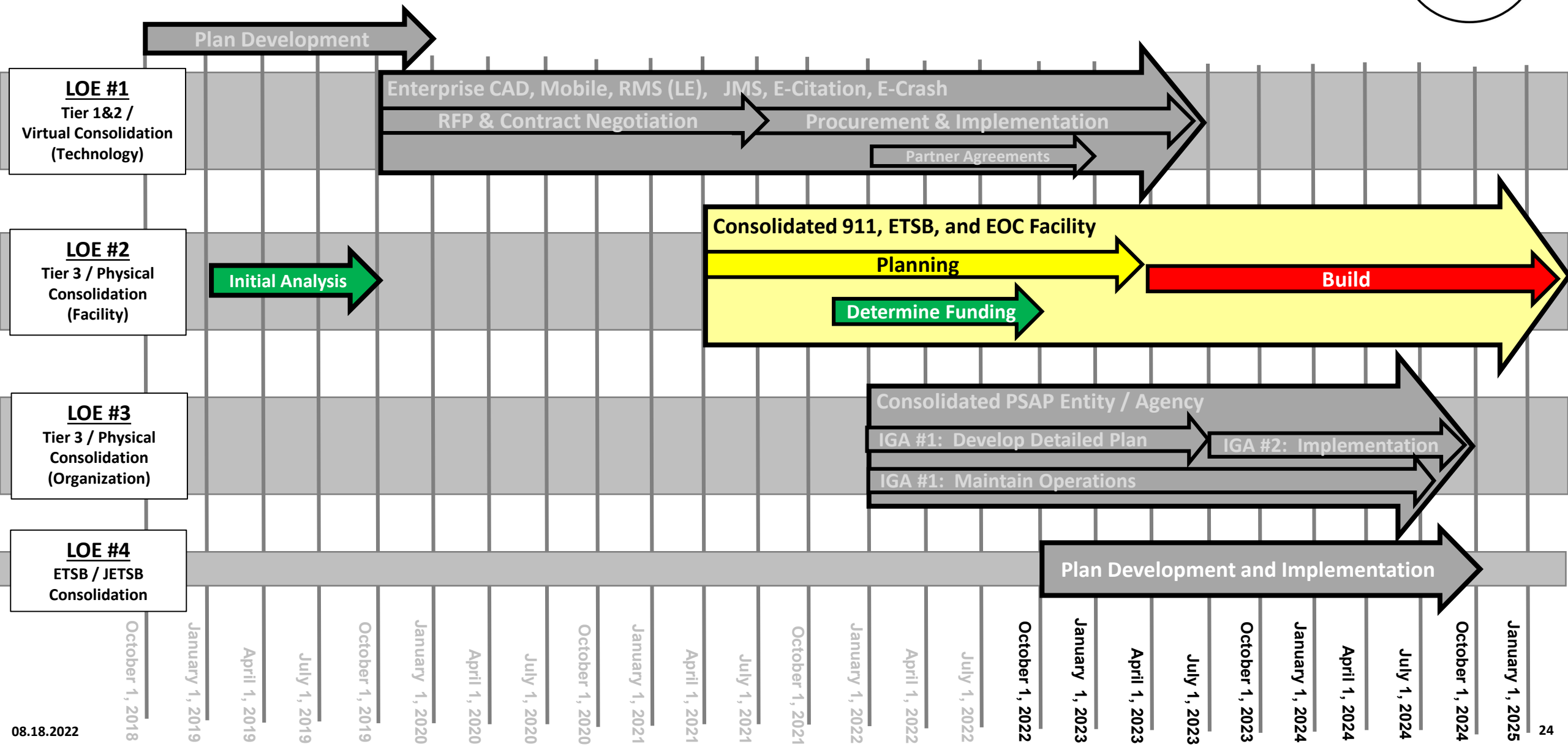
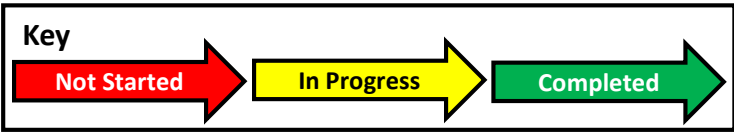

Line of Effort #2

Physical PSAP Consolidation - Facility



- Purpose-built facility for 9-1-1, Emergency Management Agency (EMA) and Emergency Telephone System Boards (ETSB)
- Building will provide:
 - Comprehensive functional space design
 - Opportunity for regional consolidation of ETSB and Public Safety Answering Points (PSAP)
 - Structural protection from severe weather and active threats
 - Provide needed permanent housing areas for emergency 9-1-1 equipment
 - 34 positions on the 9-1-1 / Communications floor
- Modernize building's environmental controls
- Design with operator wellness in mind
- Maximize sustainable design

Facility

Regional Operations & Communications Facility

Regional
9-1-1
Consolidation

Regional Operations &
Communications Facility
(ROCF)

- or -

The ROC Facility

- or -

“The ROC”

Consolidated 9-1-1, EMA, and ETSB Facility

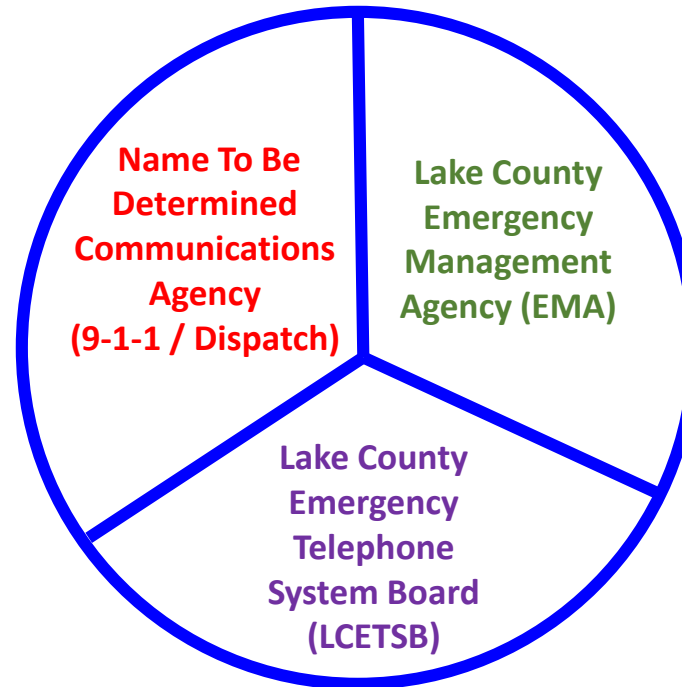

Designed to be the home to three
independent, but co-located and
mutually cooperative, agencies

Upfront capital investment
(design, build, furnish)
funded by County

Long term cost sharing
agreement

Schematic Design

Regional Operations & Communications Facility

Regional
9-1-1
Consolidation

- County's Libertyville Campus
- East to west configuration
- Maximize natural light
- Layered force protection
- Geothermal and solar power integration

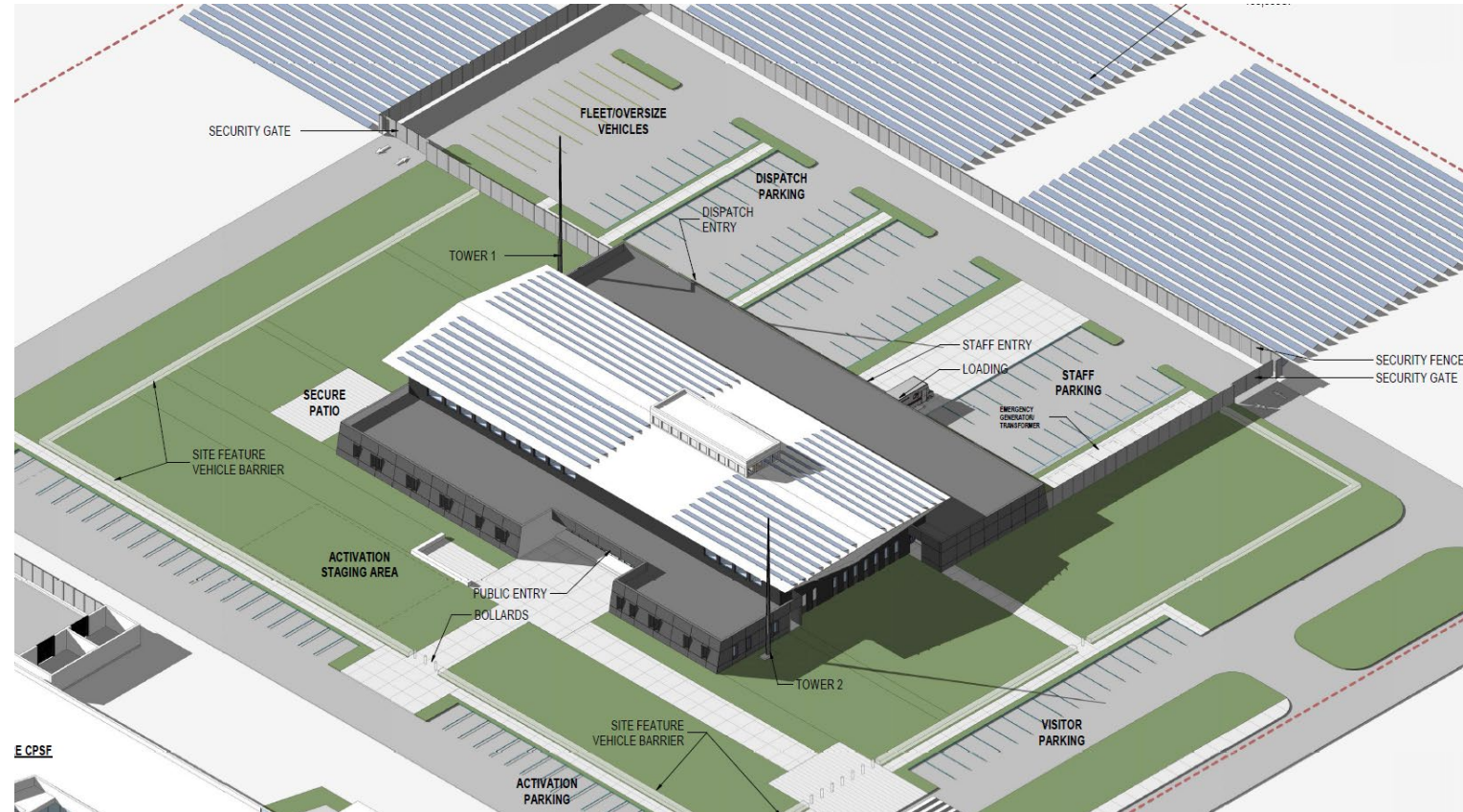

Schematic Design

Regional Operations & Communications Facility

**Regional
9-1-1
Consolidation**

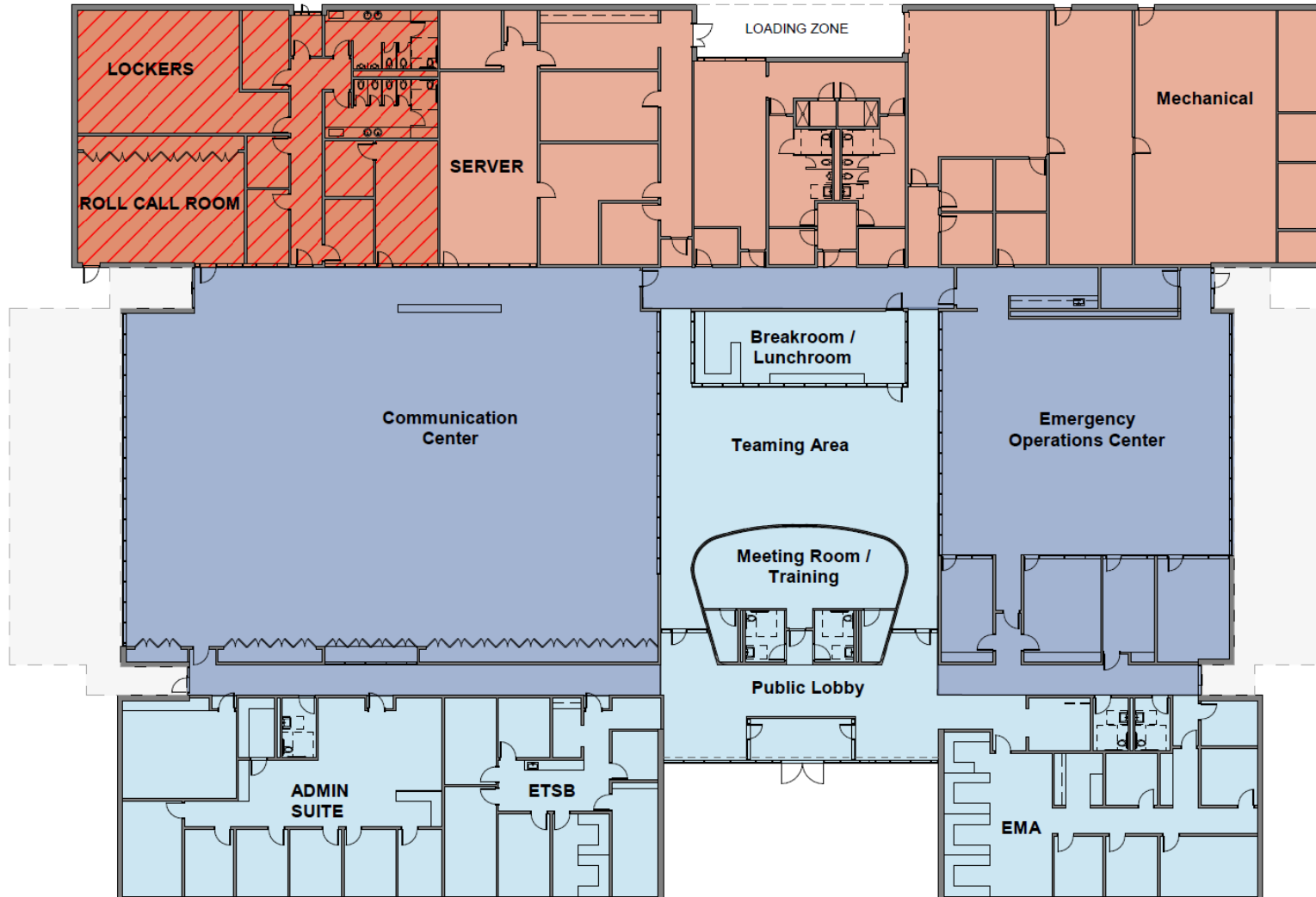

LEVELS OF HARDENING



STORM SHELTER

- Structural frame and envelope designed to meeting ICC 500
- Storm shelter rated glazing
- All openings protected
- Natural ventilation available for storm shelter area



TYPE - E (Hardened/Bunker)

- Structural frame and envelope designed to resist wind loads of 250 MPH
- Glazing to be protected and/or designed to resist _____
- All openings are protected



TYPE - D+ (National Design Trends)

- Structural frame & envelope designed to resist wind loads of 250 MPH
- Glazing & openings designed to resist 150 MPH winds (*not projectiles)



TYPE - C+ (Continuity of Operations)

- Structural frame & envelope designed to resist wind loads of 150 MPH
- Glazing & openings designed to resist 150 MPH winds (*not projectiles)

County Funding Strategy

Regional Operations & Communications Facility

\$40.0M for ROC Facility Construction

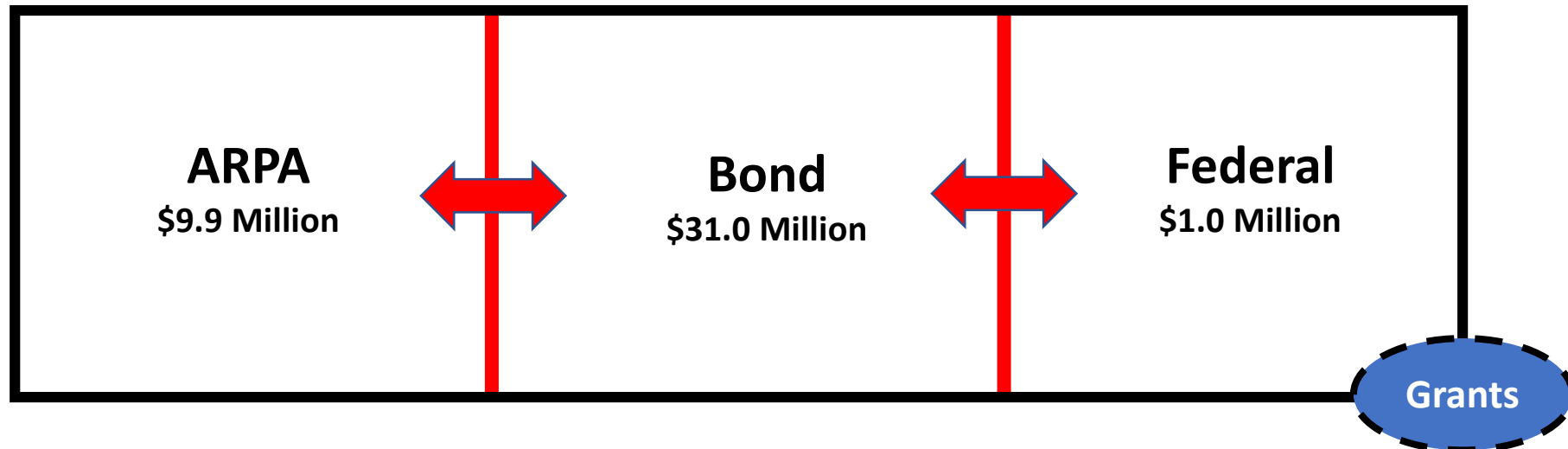

Line of Effort #2

Physical PSAP Consolidation - Facility



Way Ahead / Transition

- Maintain current working group
- Add PSAP Coordination Committee member to the ESC



Questions