



Regional Operations & Communications Facility Update

9-1-1 Operations Committee

June 16, 2022

Functional Facility Name

**Regional Operations & Communications
Facility (ROCF)**

- or -

The ROC Facility

- or -

“The ROC”

**Consolidated
9-1-1, EMA, and ETSB Facility**

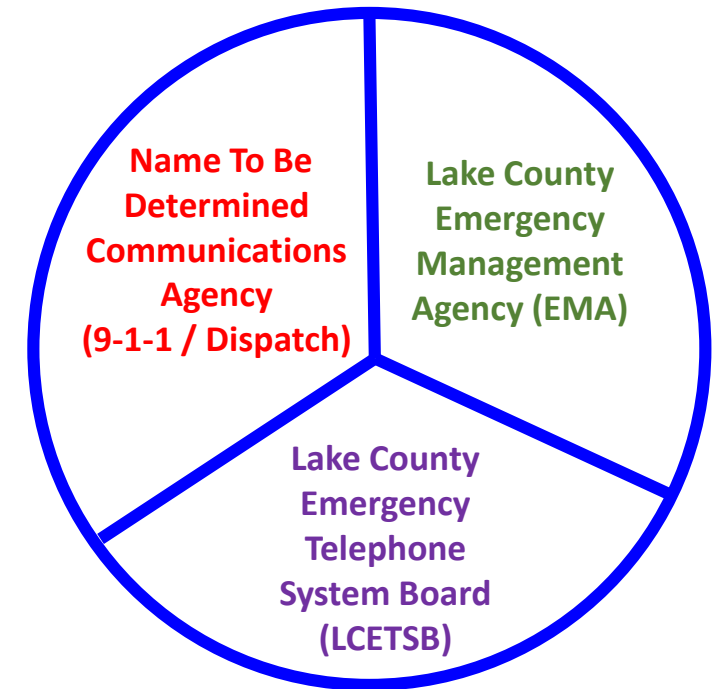

**Designed to be the home to three
independent, but co-located and
mutually cooperative, agencies**

Schematic Design

- East to West configuration
- Maximize natural light
- Layered force protection
- Geothermal and solar power integration

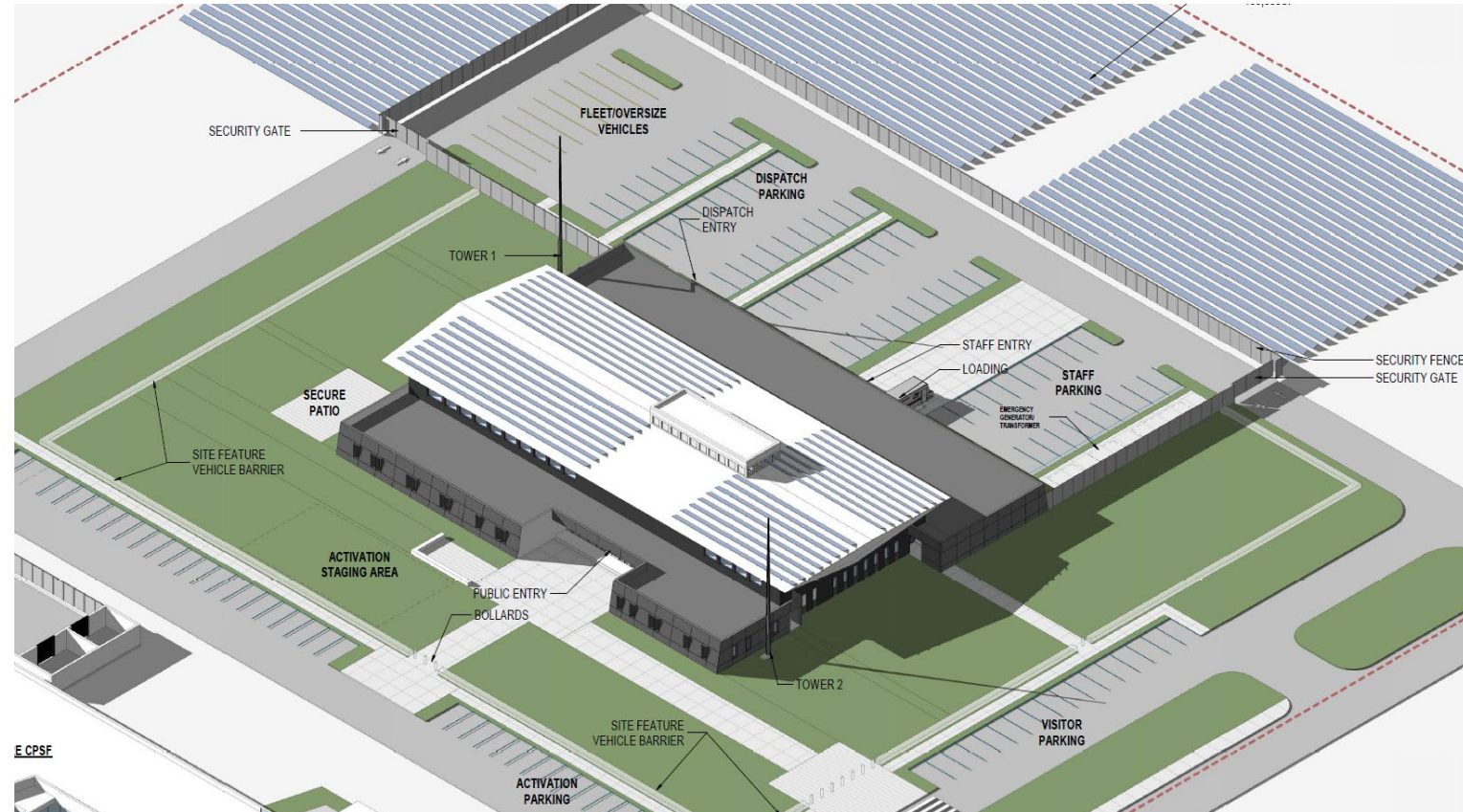

Schematic Design

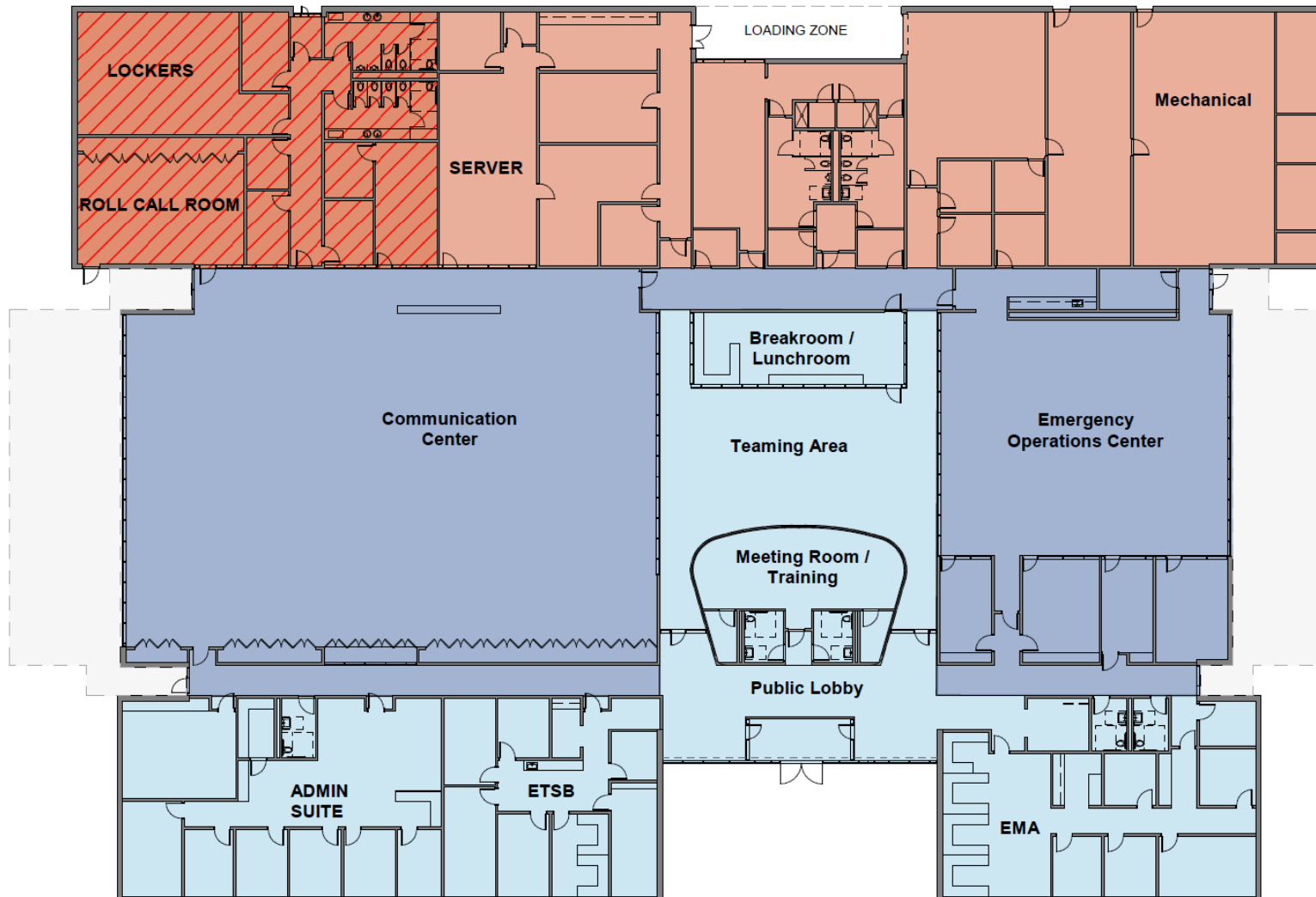

LEVELS OF HARDENING



STORM SHELTER

- Structural frame and envelope designed to meeting ICC 500
- Storm shelter rated glazing
- All openings protected
- Natural ventilation available for storm shelter area



TYPE - E (Hardened/Bunker)

- Structural frame and envelope designed to resist wind loads of 250 MPH
- Glazing to be protected and/or designed to resist _____
- All openings are protected



TYPE - D+ (National Design Trends)

- Structural frame & envelope designed to resist wind loads of 250 MPH
- Glazing & openings designed to resist 150 MPH winds (*not projectiles)



TYPE - C+ (Continuity of Operations)

- Structural frame & envelope designed to resist wind loads of 150 MPH
- Glazing & openings designed to resist 150 MPH winds (*not projectiles)

Funding

Regional Operations & Communications Facility



\$41.9M in funding for ROC Facility

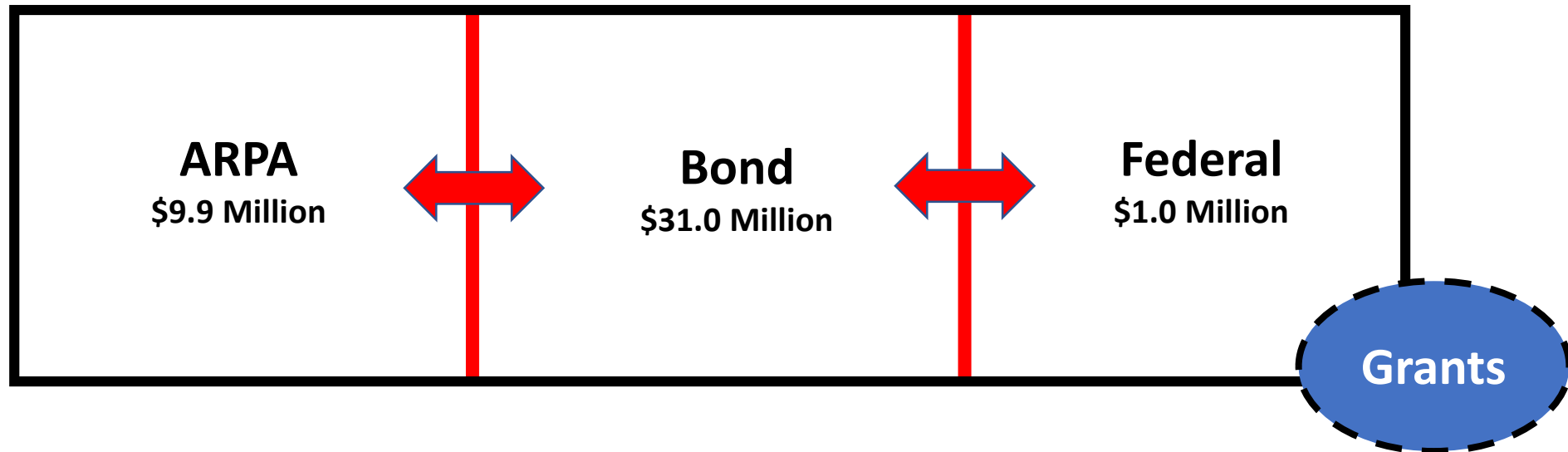

Next Steps

- Present final decision points to Lake County F&A Committee (July 2022)
 - Design standard (structural design)
 - Sustainability (geothermal and solar)
- County's funding strategy
 - ARPA (\$9.9M "Direct") - Approved
 - Federal Omnibus Bill (\$1.0M) - Approved
 - Bonding (\$31.0M)
 - On May 14th, County Board approved next step of process
 - Plan on final approval in August with funds available by October 2022
 - Grants (Continue to research infrastructure and energy grants)



Questions

Overview

911/EOC/ETSB Project Scope and Requirement



- Purpose-built facility for 911, Emergency Management Agency (EMA) and Emergency Telephone System Boards (ETSB)
- Building will provide:
 - Comprehensive functional space design
 - Opportunity for regional consolidation of ETSB and Public Safety Answering Points (PSAP)
 - Structural protection from severe weather and active threats
 - Provide needed permanent housing areas for emergency 911 equipment
 - 34 positions on the 9-1-1 / Communications floor
- Modernize the building's environmental controls
- Design with operator wellness in mind
- Maximize sustainable design

Design Principles



The New Consolidated 911/EOC/ETSB Building should...

1. Support efficient and effective emergency communications and emergency management operations and responses to public safety events for the communities served through creative and efficient design
2. Be an example of a facility 'done right' and a model of excellence in a supporting multitude of objectives, including: operations, accreditation, sustainability/energy efficiency, survivability, serviceability, and durability
3. Accommodate the needs of both today and tomorrow's environment by being expandable, flexible, functional, and a good place to work
4. Emphasize staff wellness and retention through workplace design
5. Represent the best value to the taxpayers through being environmentally friendly, efficient, practical, and effective
6. Maximize the optimization of shared spaces that can be accessed by the users of the building, as well as by other County personnel
7. Provide optimal physical security and resiliency
8. Support achievement of high levels of employee thermal comfort, access to natural daylight, and physical well-being