



UPDATE: 911/EOC/ETSB Design

911 Operations Committee

**Carl Kirar (FCS)
April 7, 2022**

911/EOC/ETSB Building

2019 Strategic Plan Alignment



County's Mission: Deliver exceptional, financially and environmentally responsive / responsible services that promote a safe, affordable, healthy, and resilient community

Strategic Initiatives	
X	Regional Leadership
X	Fiscal Responsibility
X	Exceptional Service and Operational Excellence
Strategic Goals	
	Public Safety and Integrated, Data-Driven Justice System
X	Enhance Economic Opportunities
X	Improve Infrastructure
X	Promote a Sustainable Environment
	Build Healthy, Inclusive, and Resilient Communities

Strategic Themes	
	Inter-Organizational Cooperation
X	Quality of Life
X	Economic Development
X	Infrastructure
X	Environmental Sustainability
X	Non-Environmental Sustainability
X	Lake County Branding
	Mental Health
X	Grants and Specialty Funding
	Diversity and Inclusion

[Link to Strategic Plan](#)

- **Purpose**

- Status update and discussion of 911/EOC/ETSB project.

- **Agenda**

- **Overview of project**
 - Schematic Design Options
 - Discussion Items:
 - Funding
 - Basement
 - Next Steps

Overview

911/EOC/ETSB Project Scope and Requirement



- **Purpose-built facility for 911, Emergency Management Agency (EMA) and Emergency Telephone System Boards (ETSB)**
- **Building will provide:**
 - **Comprehensive functional space design**
 - **Opportunity for regional consolidation of ETSB and Public Safety Answering Points (PSAP)**
 - **Structural protection from severe weather and active threats**
 - **Provide needed permanent housing areas for emergency 911 equipment**
- **Modernize the building's environmental controls**
- **Design with operator wellness in mind**
- **Next Generation 911 (additional space requirements for added equipment)**
- **Maximize sustainable design**

Overview

Design Roles and Responsibilities

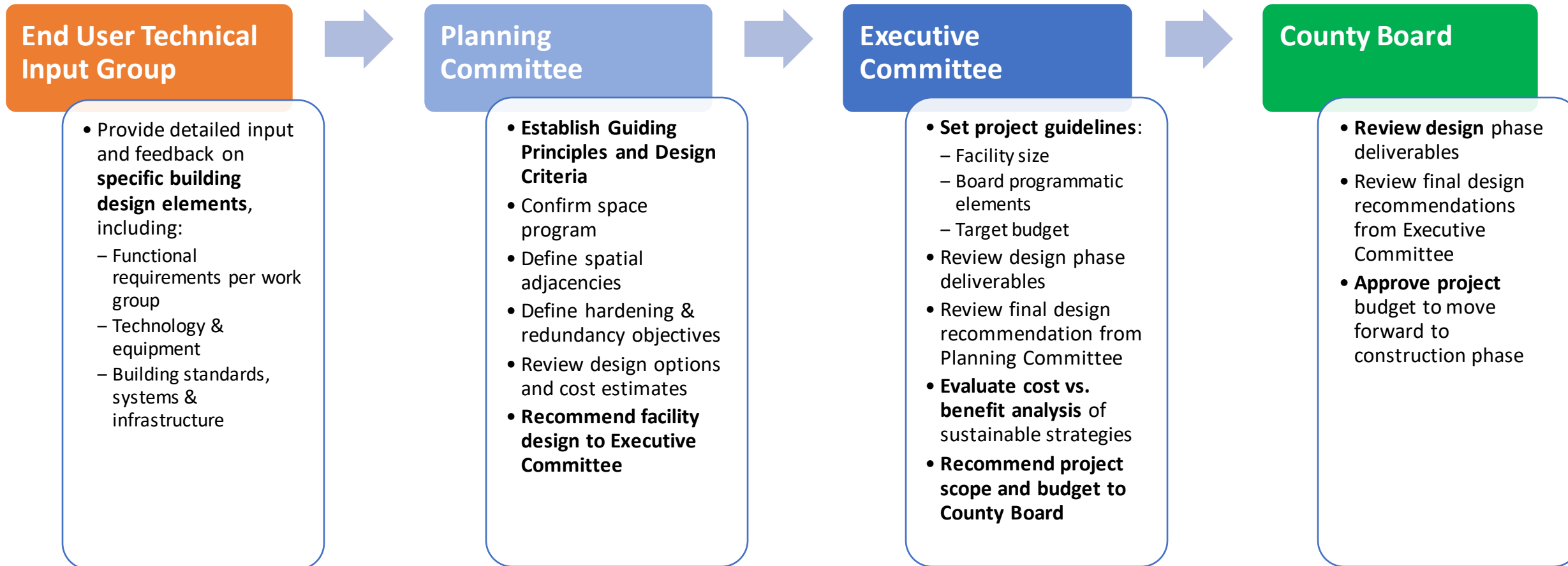

Overview

Design Principles



The New Consolidated 911/EOC/ETSB Building should...

1. Support efficient and effective emergency communications and emergency management operations and responses to public safety events for the communities served through creative and efficient design.
2. Be an example of a facility 'done right' and a model of excellence in a supporting multitude of objectives, including: operations, accreditation, sustainability/energy efficiency, survivability, serviceability, and durability.
3. Accommodate the needs of both today and tomorrow's environment by being expandable, flexible, functional, and a good place to work.
4. Emphasize staff wellness and retention through workplace design.
5. Represent the best value to the taxpayers through being environmentally friendly, efficient, practical, and effective.
6. Maximize the optimization of shared spaces that can be accessed by the users of the building, as well as by other County personnel.
7. Provide optimal physical security and resiliency.
8. Support achievement of high levels of employee thermal comfort, access to natural daylight, and physical well-being.

- **Purpose**
 - Status update and discussion of 911/EOC/ETSB project.

- **Agenda**
 - Overview of project
 - **Schematic Design**
 - Discussion Items:
 - Funding
 - Basement
 - Next Steps

Schematic Design

- East to West configuration
- Maximize natural light
- Layered force protection
- Geothermal and Solar Power integration

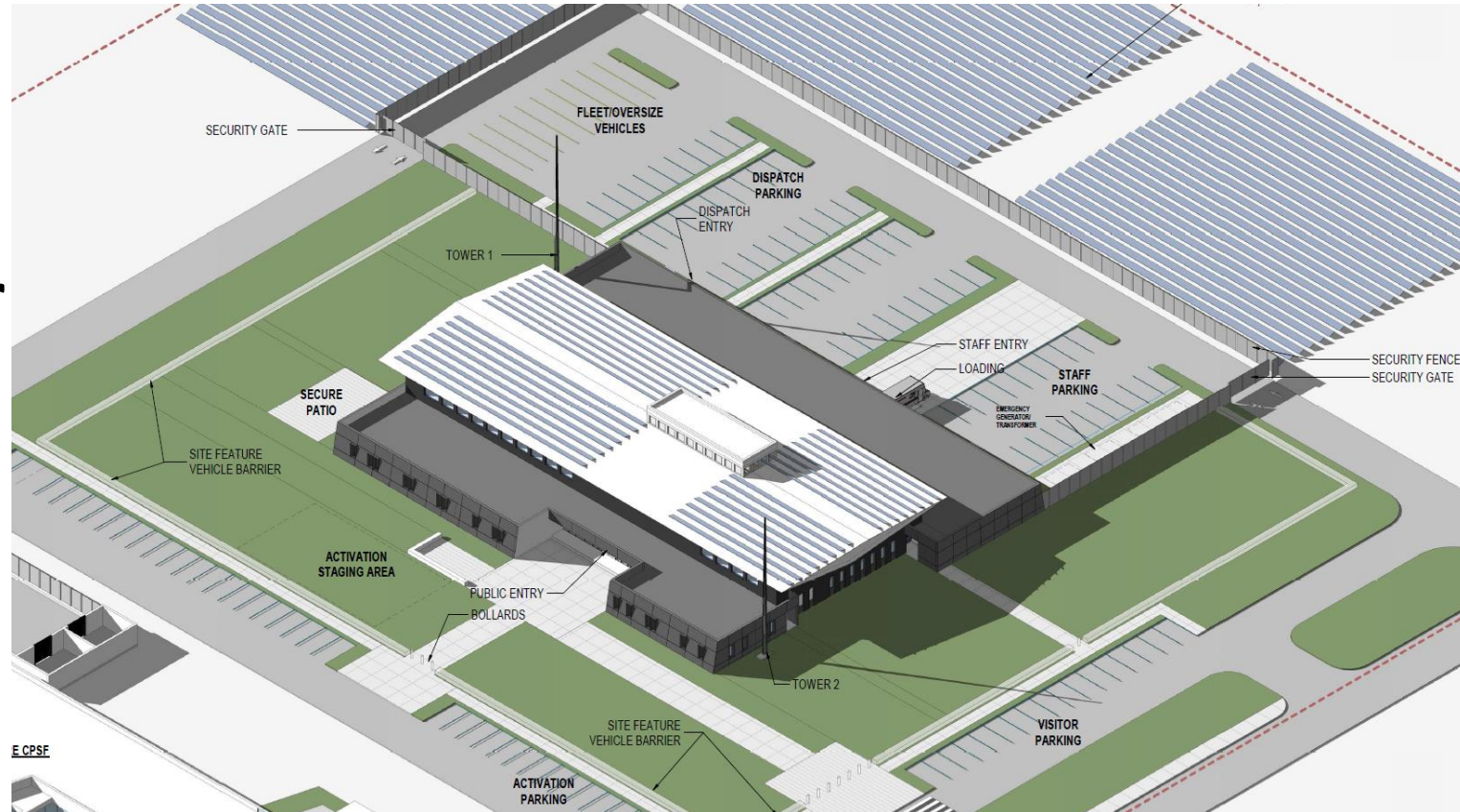

Schematic Design

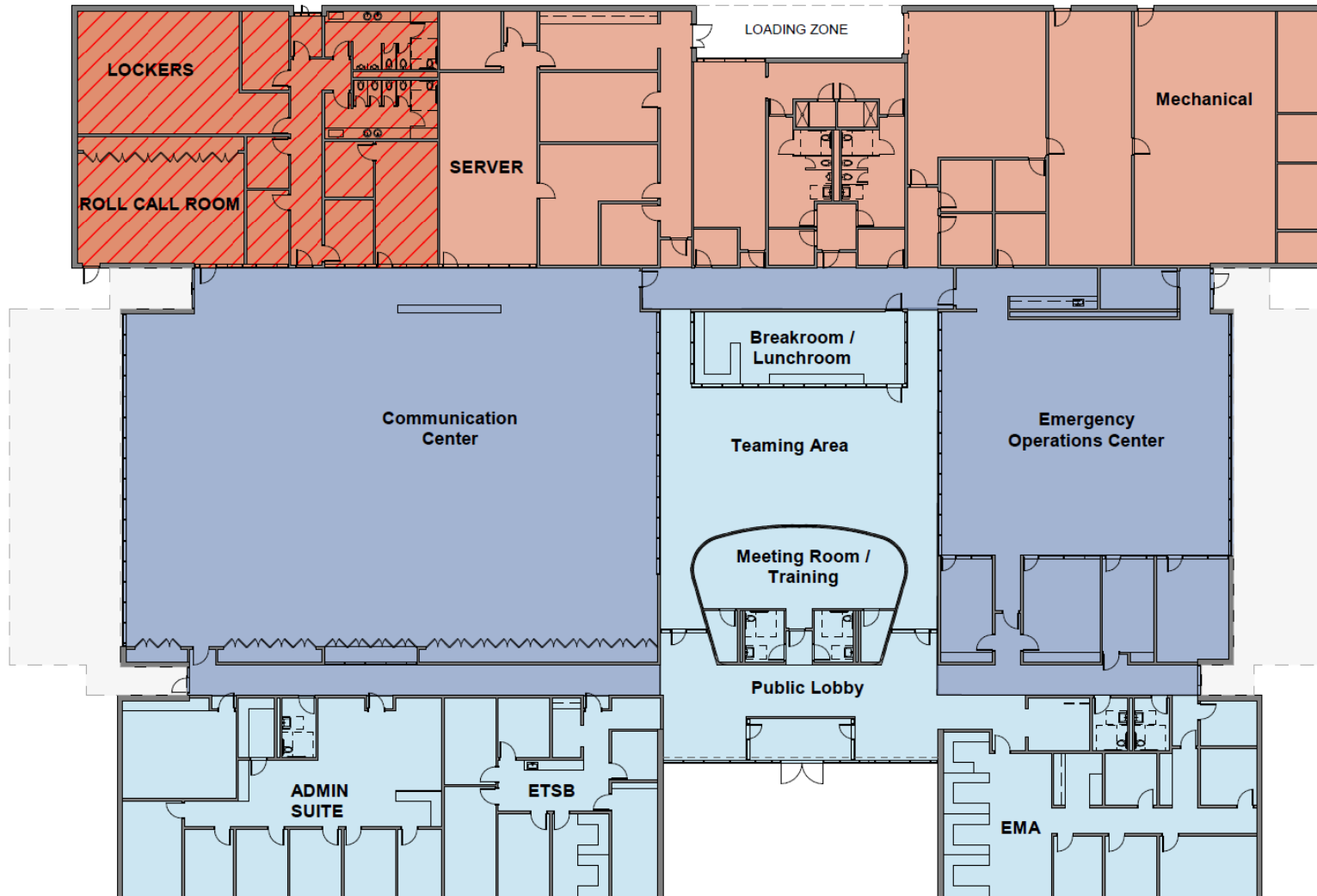

LEVELS OF HARDENING



STORM SHELTER

- Structural frame and envelope designed to meeting ICC 500
- Storm shelter rated glazing
- All openings protected
- Natural ventilation available for storm shelter area



TYPE - E (Hardened/Bunker)

- Structural frame and envelope designed to resist wind loads of 250 MPH
- Glazing to be protected and/or designed to resist _____
- All openings are protected



TYPE - D+ (National Design Trends)

- Structural frame & envelope designed to resist wind loads of 250 MPH
- Glazing & openings designed to resist 150 MPH winds (*not projectiles)



TYPE - C+ (Continuity of Operations)

- Structural frame & envelope designed to resist wind loads of 150 MPH
- Glazing & openings designed to resist 150 MPH winds (*not projectiles)

- **Purpose**

- Status update and discussion of 911/EOC/ETSB project.

- **Agenda**

- Overview of project
 - Schematic Design
 - Discussion Items:
 - Funding
 - Basement
 - Next Steps

Funding

ARPA/Bonding/Federal/Grants



\$40.0M for Consolidated EOC/911/ETSB Facility

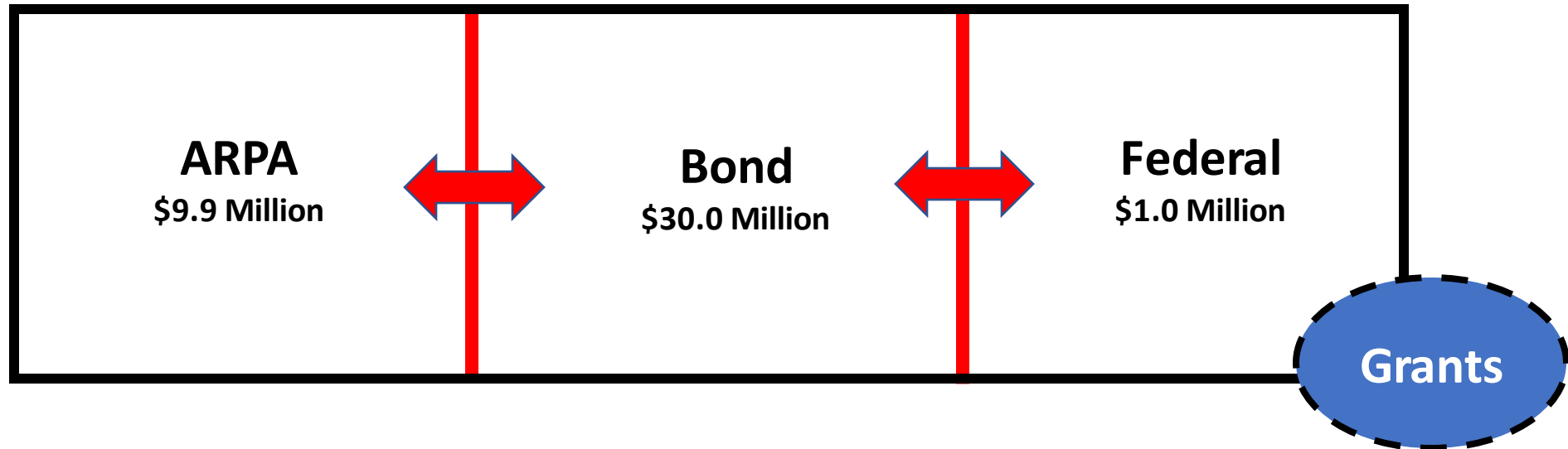

Evaluation of Basement

- **Opportunities:**
 - Potential location of storm shelter or extra storage
 - Stacked building reduces footprint on site and exposed roof area
- **Challenges:**
 - Inconsistent with stated project goals;
 - Agency operational adjacencies
 - Separating operations and administrative functions
 - Limit to function flow: only less roof if you split administrative portion of agencies to have basement as their primary operating zone – dispatchers and operations can not move downstairs
 - Redundant to required spaces; area necessary for additional mechanical equipment and stairway
 - Expensive: \$100K for elevator alone, \$100K for adjacent stairs
 - Facilities Cost become offset: less roof, but additional costs for mechanical, maintenance, and space
- **Recommendation from Designers and Operators: No Basement**

- **Purpose**

- Status update and discussion of 911/EOC/ETSB project.

- **Agenda**

- Overview of project
 - Schematic Design
 - Discussion Items:
 - Funding
 - Basement
 - Next Steps

Next Steps

- ✓ • Schematic design
- ✓ • Funding Strategy
- Design Documents:
 - Final Site and Building Planning (May 2022)
 - Material and Finish Development (June 2022)
 - Renderings (June 2022)
 - Cost Estimate (July 2022)
- Present financial decision points to F&A (July 2022)



Questions