



WORKSPACE PROPOSAL

SUBMITTED 1/10/2022



LakeCounty

AIS



INSPIRING
WORKSPACE
FURNISHINGS

CLASSROOM 01219

Customer Initials

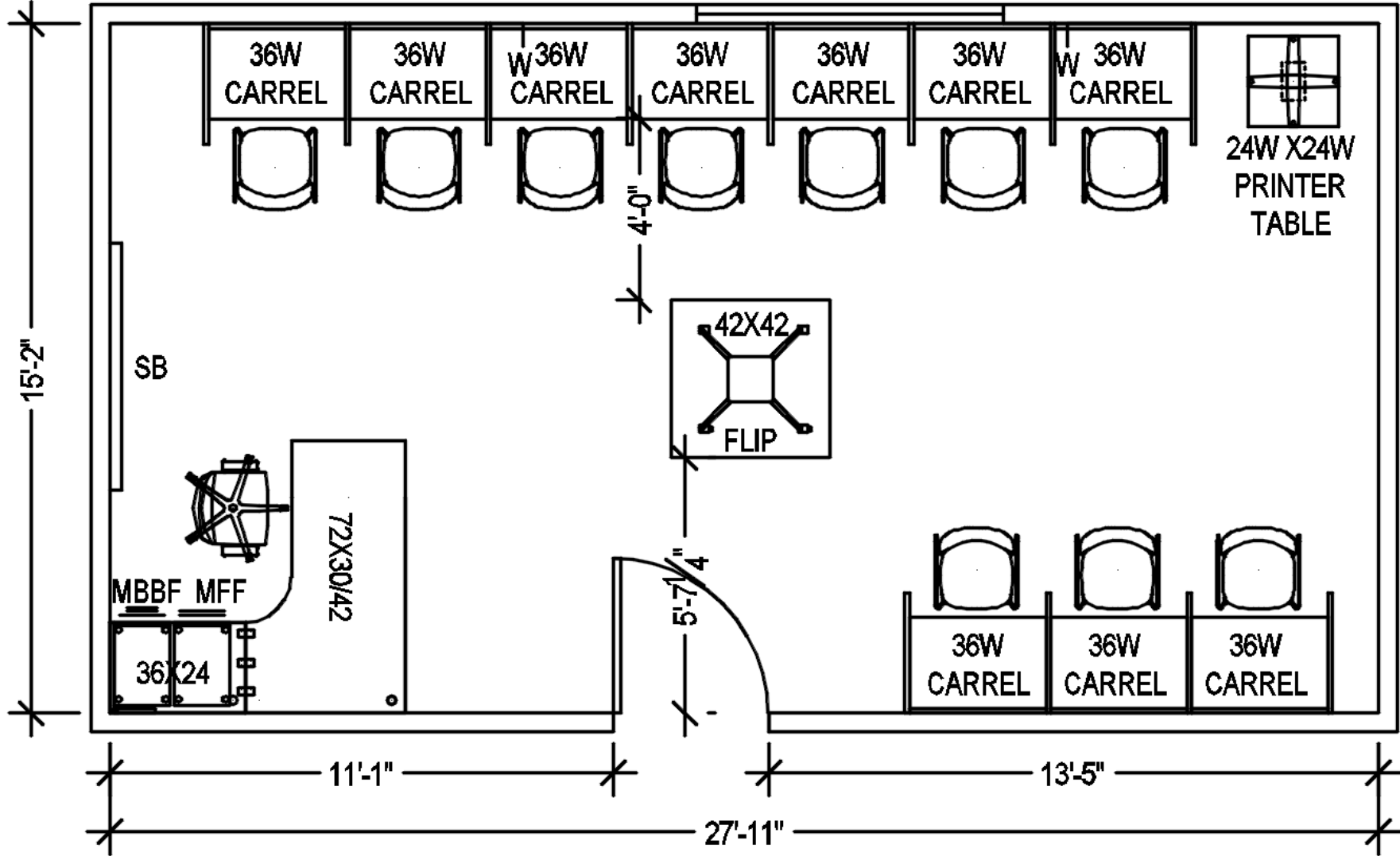

AGATI PRIMARY CARRELS

- Qty 10
- 36"W X 29"D X 48"H
- Edge: PVC
- Byrne Dean & 4Trac Power
- Laminate/Edge: Wilsonart Monticello Maple
- Power Module: Black
- 1/2 modesty (not what is shown in the picture)

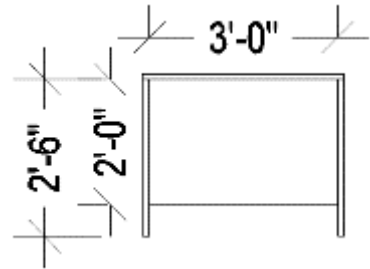

AIS CALIBRATE DESK / TABLE

- Laminate: Monticello Maple (Gr B)
- Edgeband: Black
- Trim: Black
- Grommets: Black
- Handle: Black Rail
- (1) Bolton Task Chair
- (10) Maari Side Chairs

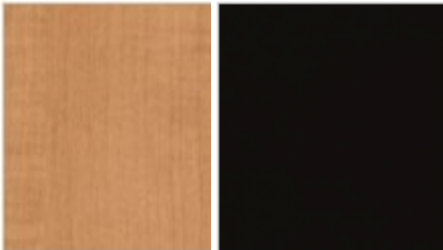

SURFACE WORKS EXTOL TABLE

- 42" X 42" Laminate Square Top
- Flip-Top
- EB Edge
- Locking Casters



CLASSROOM 01220

Customer Initials

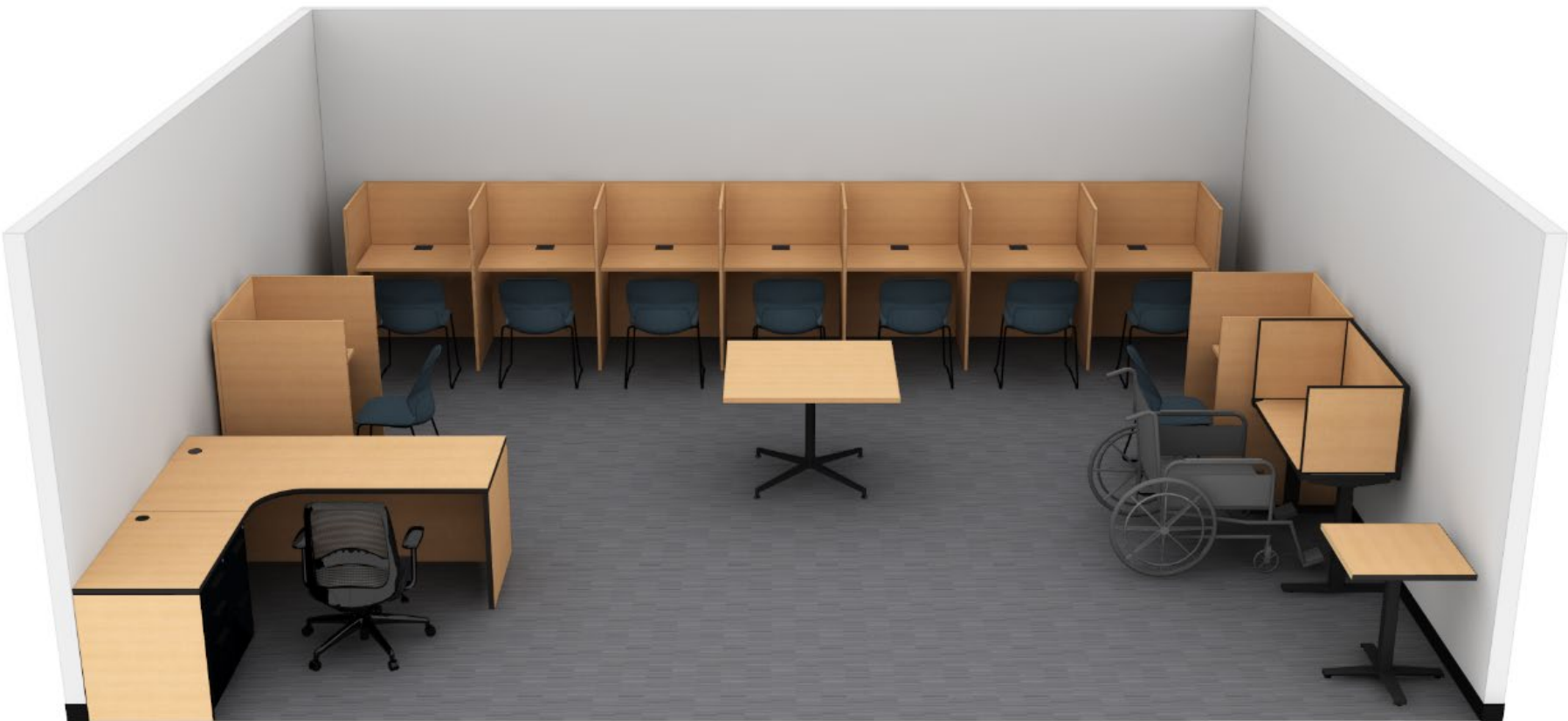
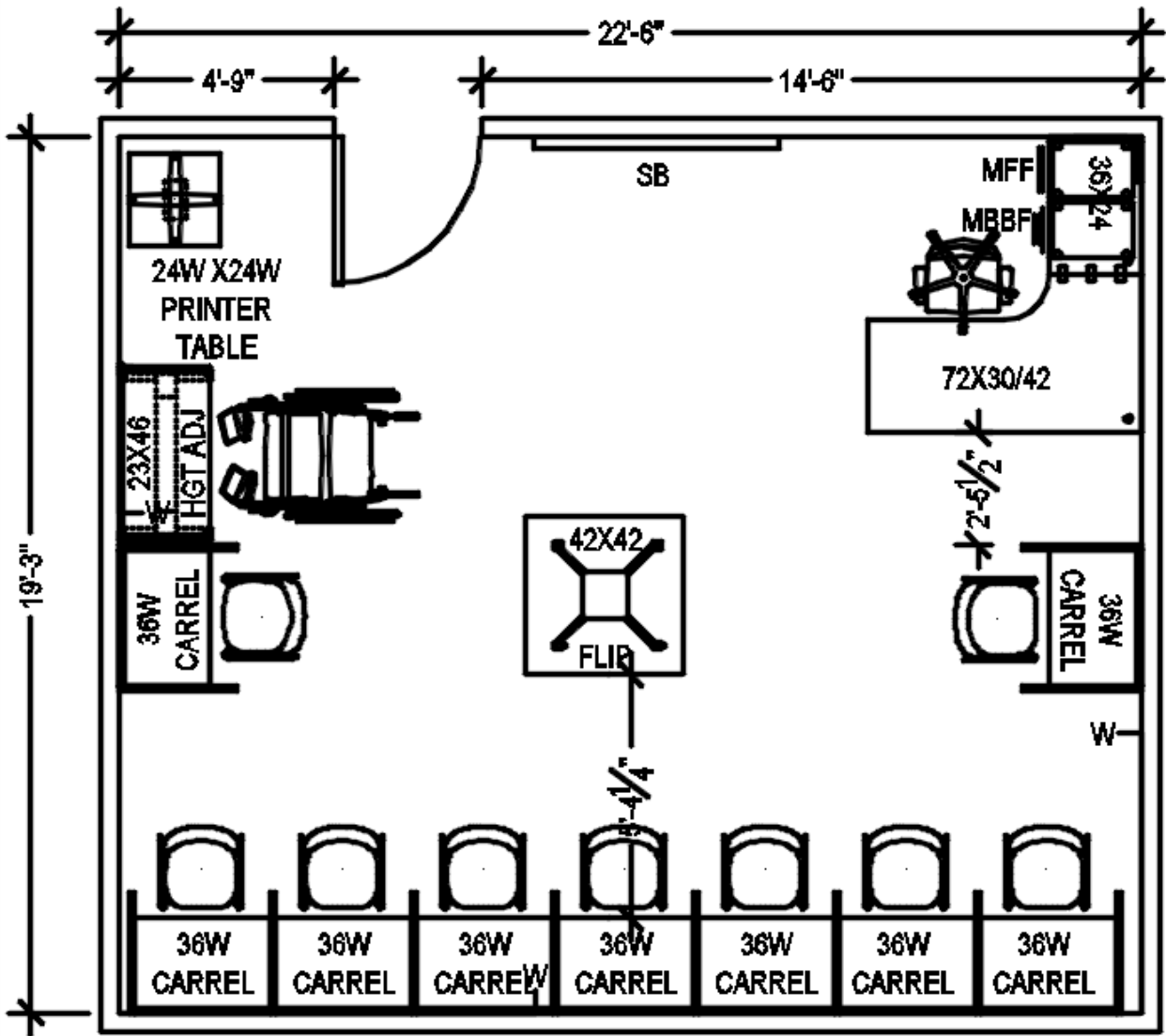

AGATI PRIMARY CARRELS

- Qty 9
- 36"W X 29"D X 48"H
- Edge: PVC
- Byrne Dean & 4Trac Power
- Laminate/Edge: Wilsonart Monticello Maple
- Power Module: Black
- 1/2 modesty (not what is shown in the picture)

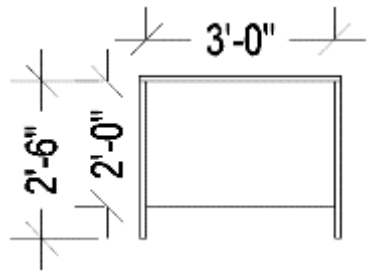

AIS CALIBRATE DESK / TABLE

- Laminate: Monticello Maple (Gr B)
- Edgeband: Black
- Trim: Black
- Handle: Black Rail
- (1) Bolton Task Chair
- (9) Maari Side Chairs

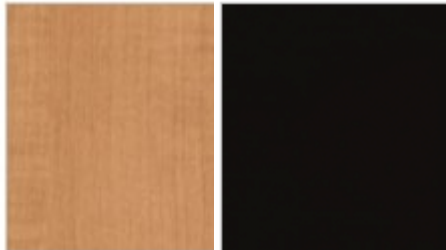

SURFACE WORKS EXTOL TABLE

- 42" X 42" Laminate Square Top
- Flip-Top
- EB Edge
- Locking Casters



CLASSROOM 01221

Customer Initials

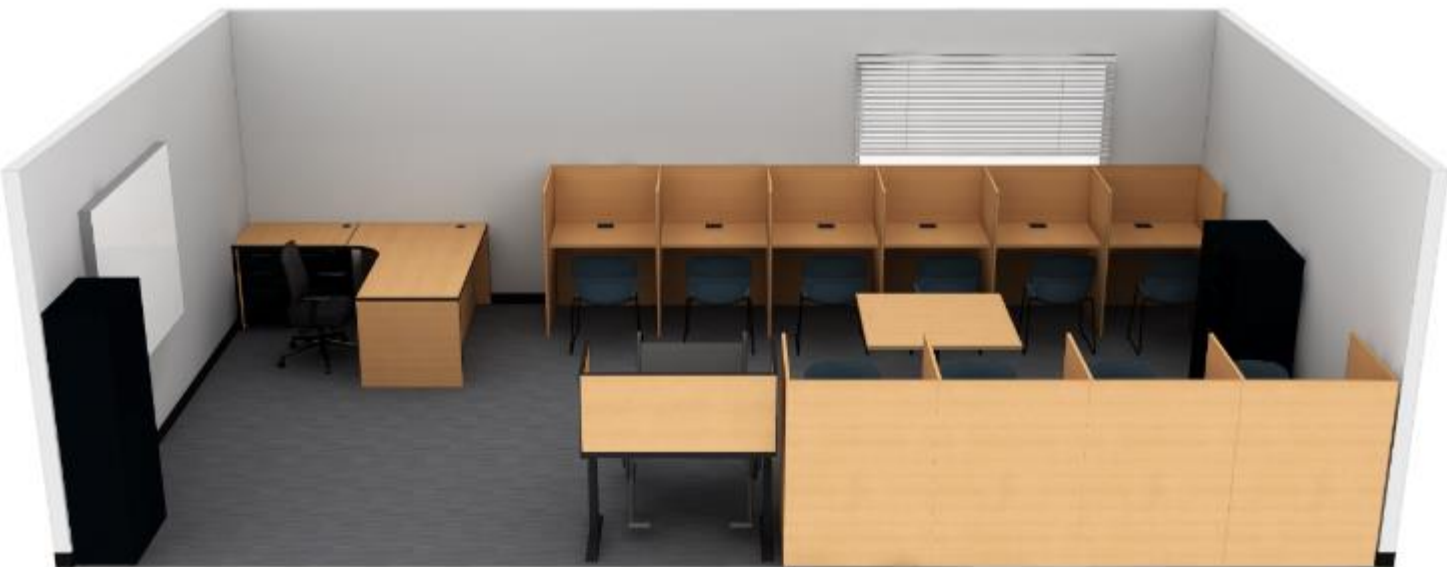
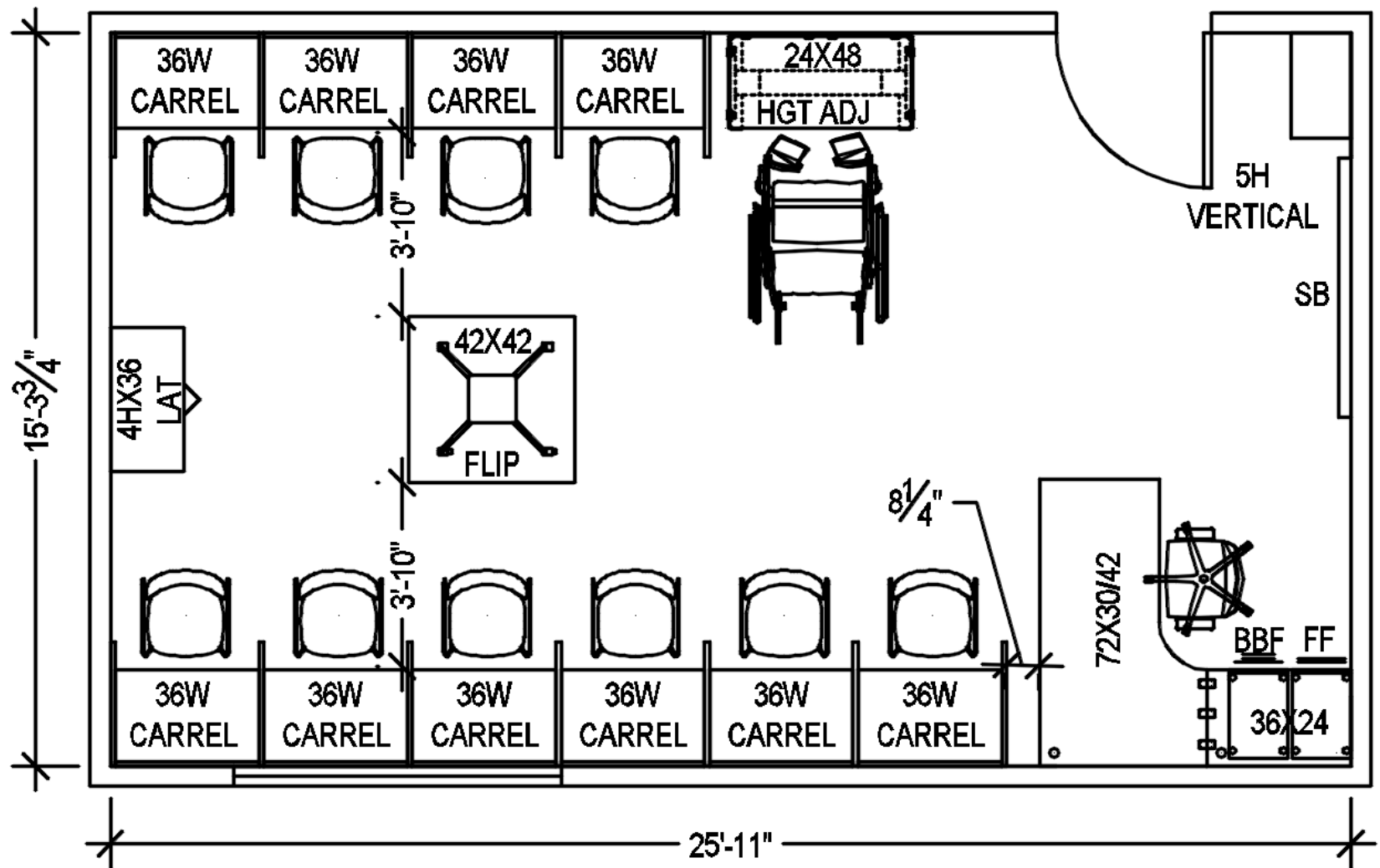

AGATI PRIMARY CARRELS

- Qty 10
- 36"W X 29"D X 48"H
- Edge: PVC
- Byrne Dean & 4Trac Power
- Laminate/Edge: Wilsonart Monticello Maple
- Power Module: Black
- 1/2 modesty (not what is shown in the picture)



Monticello Maple 7925-38
Doellken 4894

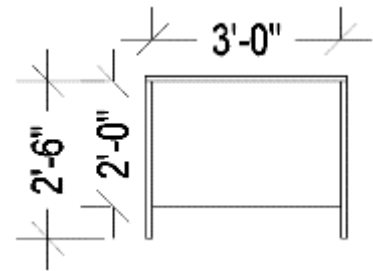

AIS CALIBRATE DESK / TABLE

- Laminate: Monticello Maple (Gr B)
- Edgeband: Black
- Trim: Black
- Handle: Black Rail
- (1) Bolton Task Chair
- (9) Maari Side Chairs

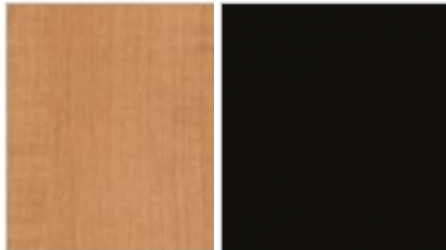

Monticello Maple Black
BK



Black Rail Pull

SURFACE WORKS EXTOL TABLE

- 42" X 42" Laminate Square Top
- Flip-Top
- EB Edge
- Locking Casters



Monticello Maple



B300 BLACK

CLASSROOM 01227

Customer Initials

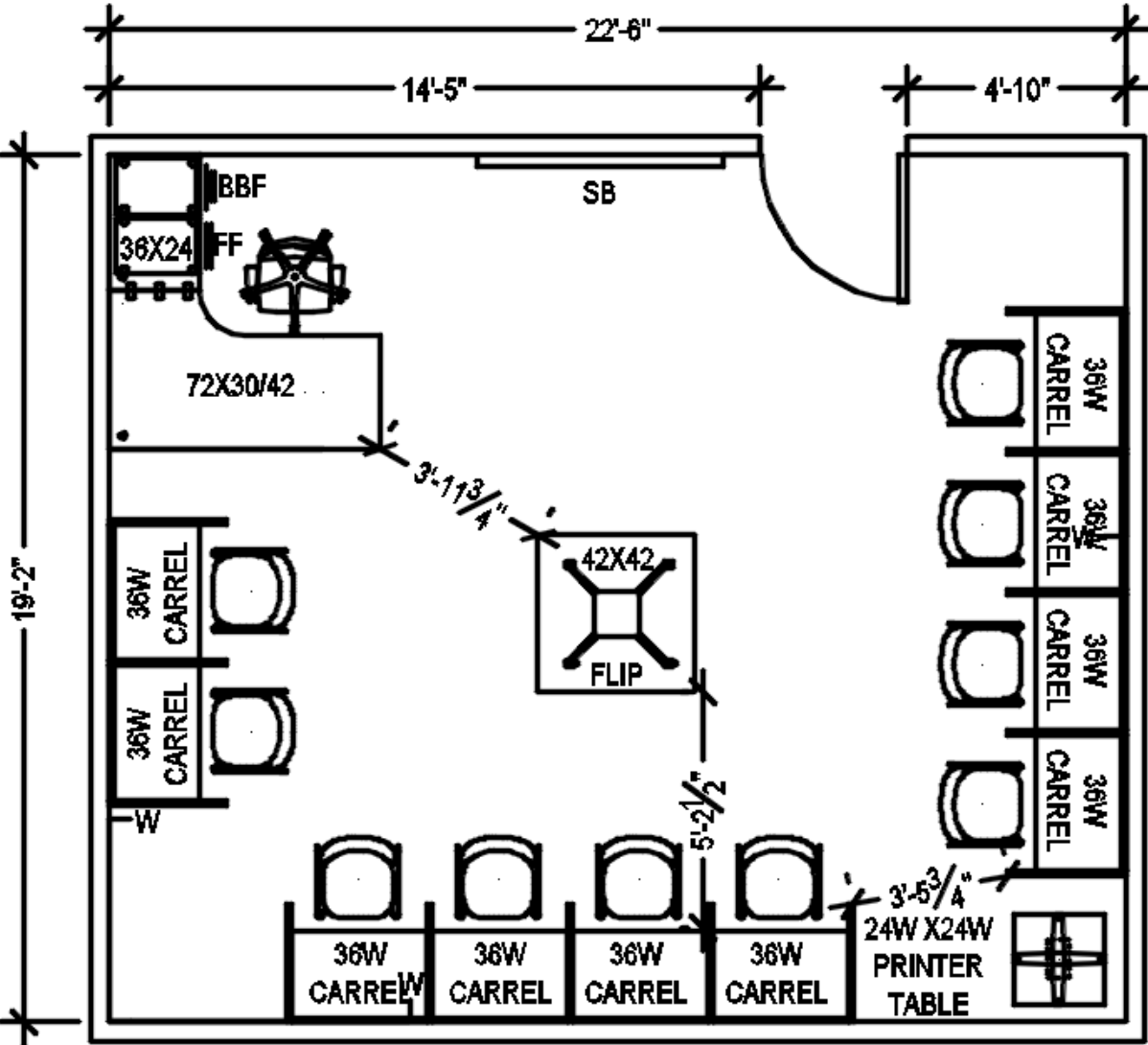

AGATI PRIMARY CARRELS

- Qty 10
- 36"W X 29"D X 48"H
- Edge: PVC
- Byrne Dean & 4Trac Power
- Laminate/Edge: Wilsonart Monticello Maple
- Power Module: Black
- 1/2 modesty (not what is shown in the picture)

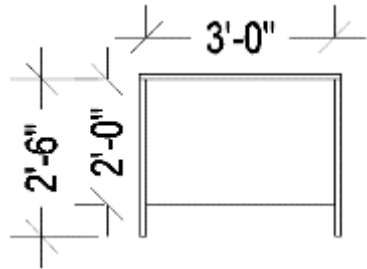

AIS CALIBRATE DESK / TABLE

- Laminate: Monticello Maple (Gr B)
- Edgeband: Black
- Trim: Black
- Handle: Black Rail
- (1) Bolton Task Chair
- (10) Maari Side Chairs

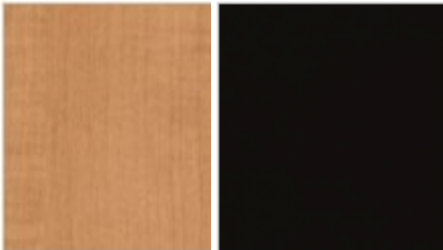

SURFACE WORKS EXTOL TABLE

- 42" X 42" Laminate Square Top
- Flip-Top
- EB Edge
- Locking Casters



CLASSROOM 01705

Customer Initials

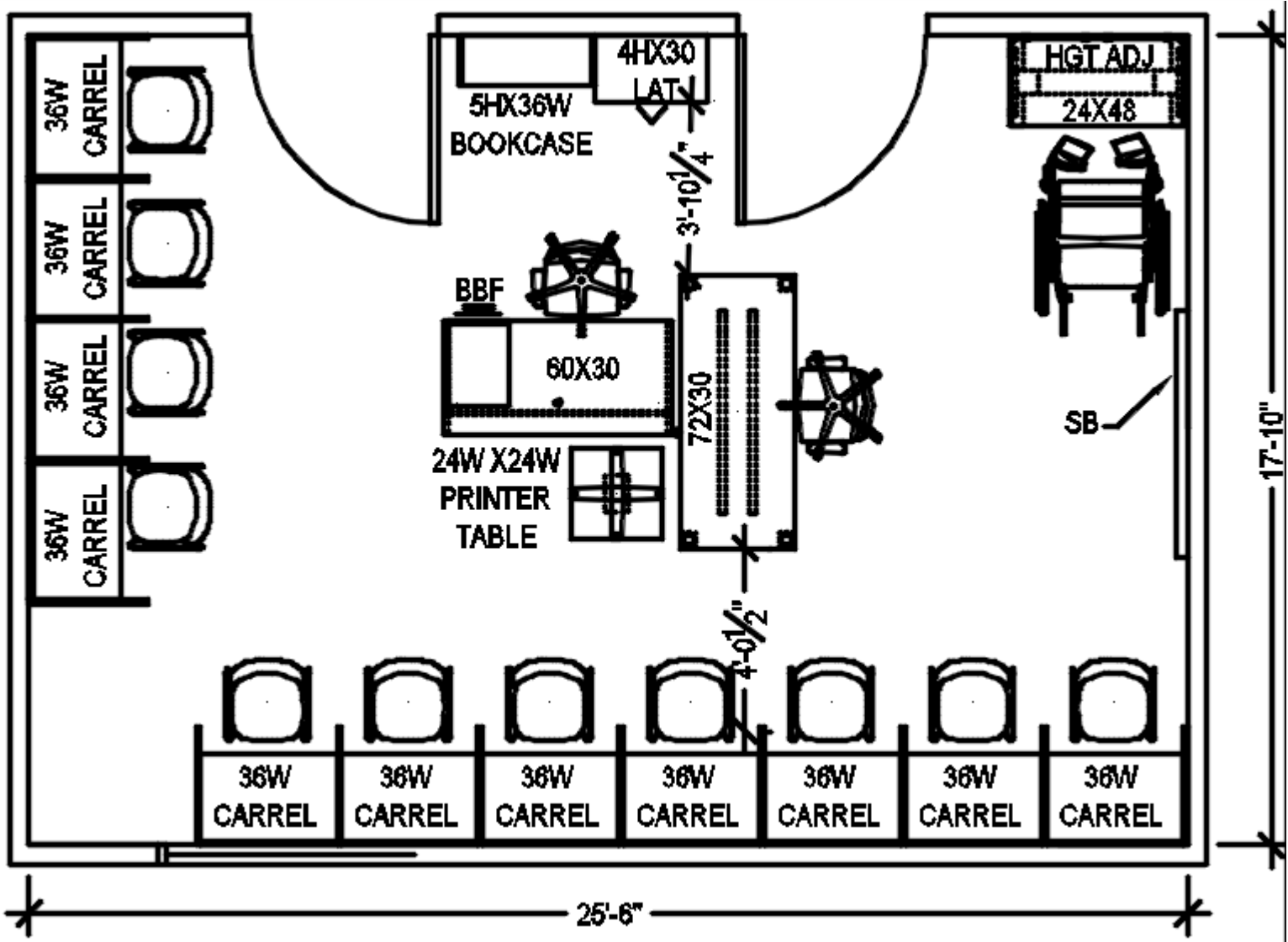

AGATI PRIMARY CARRELS

- Qty 11
- 36"W X 29"D X 48"H
- Edge: PVC
- Byrne Dean & 4Trac Power
- Laminate/Edge: Wilsonart Monticello Maple
- Power Module: Black
- 1/2 modesty (not what is shown in the picture)



Monticello Maple 7925-38
Doellken 4894

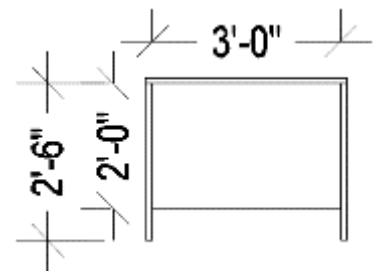

AIS CALIBRATE DESK / TABLE

- Laminate: Monticello Maple (gr B)
- Edgeband: Black
- Trim: Black
- Handle: Black Rail
- (2) Bolton Task Chairs
- (11) Maari Side Chairs

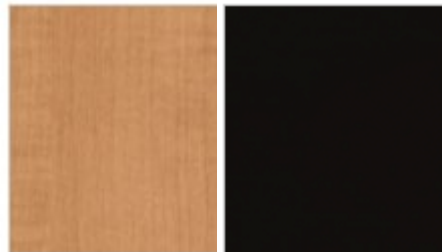

Monticello Maple Black
BK



Black Rail Pull



STUDY CARRELS

Customer Initials

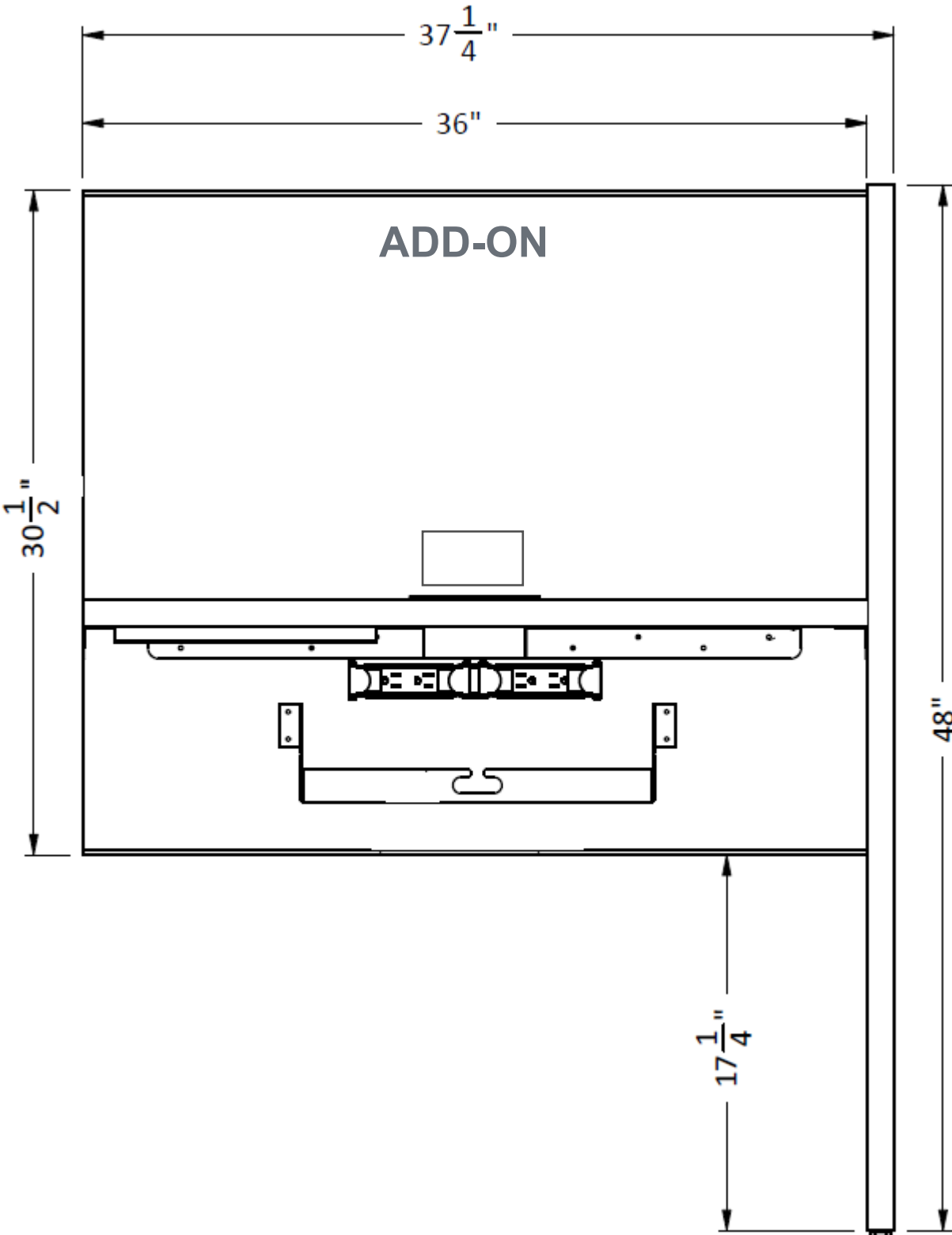
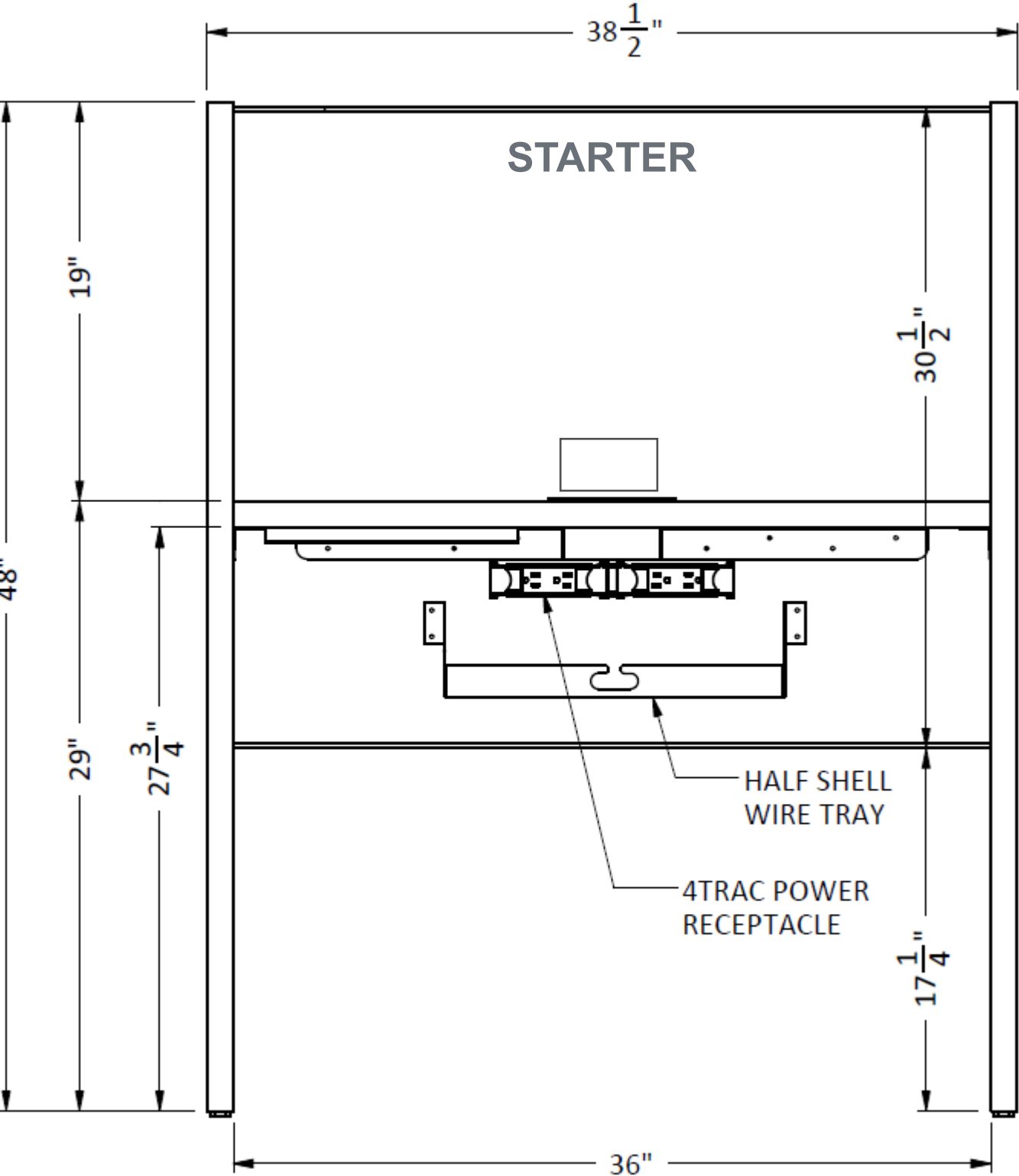

STUDY CARRELS

Customer Initials

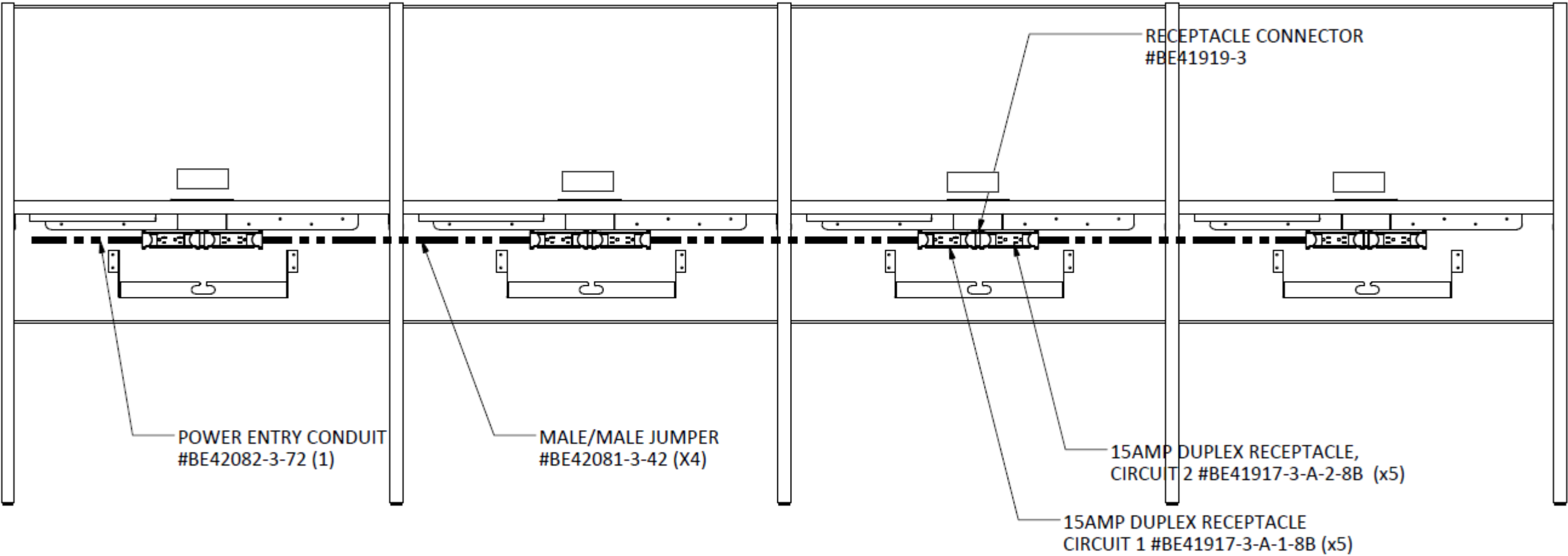

AGATI PRIMARY CARRELS

- 36"W X 29"D X 48"H
- Edge: PVC
- (1) Byrne Dean Surface Mounted Power Module W/ (1) Outlet & (1) Dual USB Charger, 15 Amp 6' Power Cord
- Back Mounted Half Shell Wire Management Tray in .063 Aluminum & Black Finish
- Screw Mount Cable Ties in Black
- Wire Channel in Black
- Byrne 4 Trac Hardwired Electrical System (Configured For 2 Circuit)
 - 15 Amp Duplex Receptacle, Circuit 1
 - 15 Amp Duplex Receptacle, Circuit 2
- Laminate/Edge: Wilsonart Monticello Maple 7925-38 Doellkin 4894
- Power Module: Black



Monticello Maple 7925-38
Doellkin 4894



Half modesty so we have access to the wall for data and electrical.



FLIP-TOP TABLES



FLIP-TOP RECTANGULAR TABLE (QTY 7)

- AIS Everyday
- 72”X30”
- Flip On Casters
- Laminate Top: Monticello Maple (Gr B)
- Edgeband Black
- Leg Finish: Silver (Std)

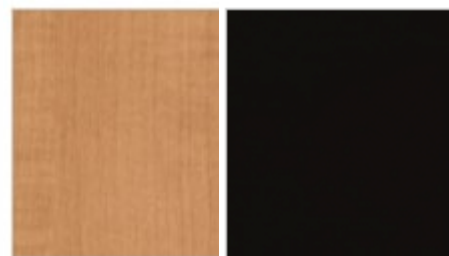

Monticello Maple Black
BK

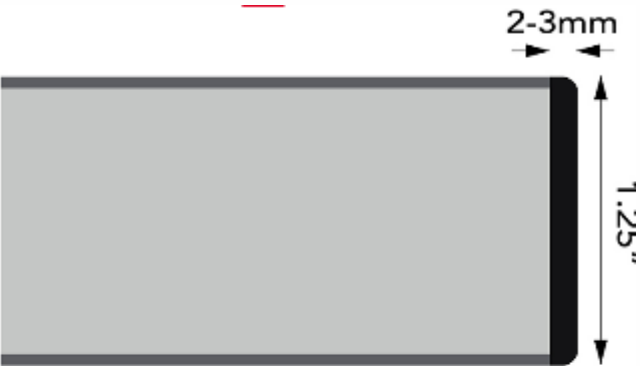

EB
Flat Profile
Square Corner Thick Edgeband

FLIP-TOP SQUARE TABLE (QTY 4)

- Surface Works Extol
- 42” X 42” Laminate Square Top
- Flip-Top
- EB Edge
- Locking Casters
- Laminate Top: Wilsonart Monticello Maple
- Base: Black

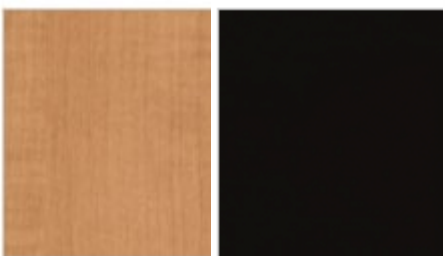

Monticello Maple Black

MISC TABLES

Customer Initials

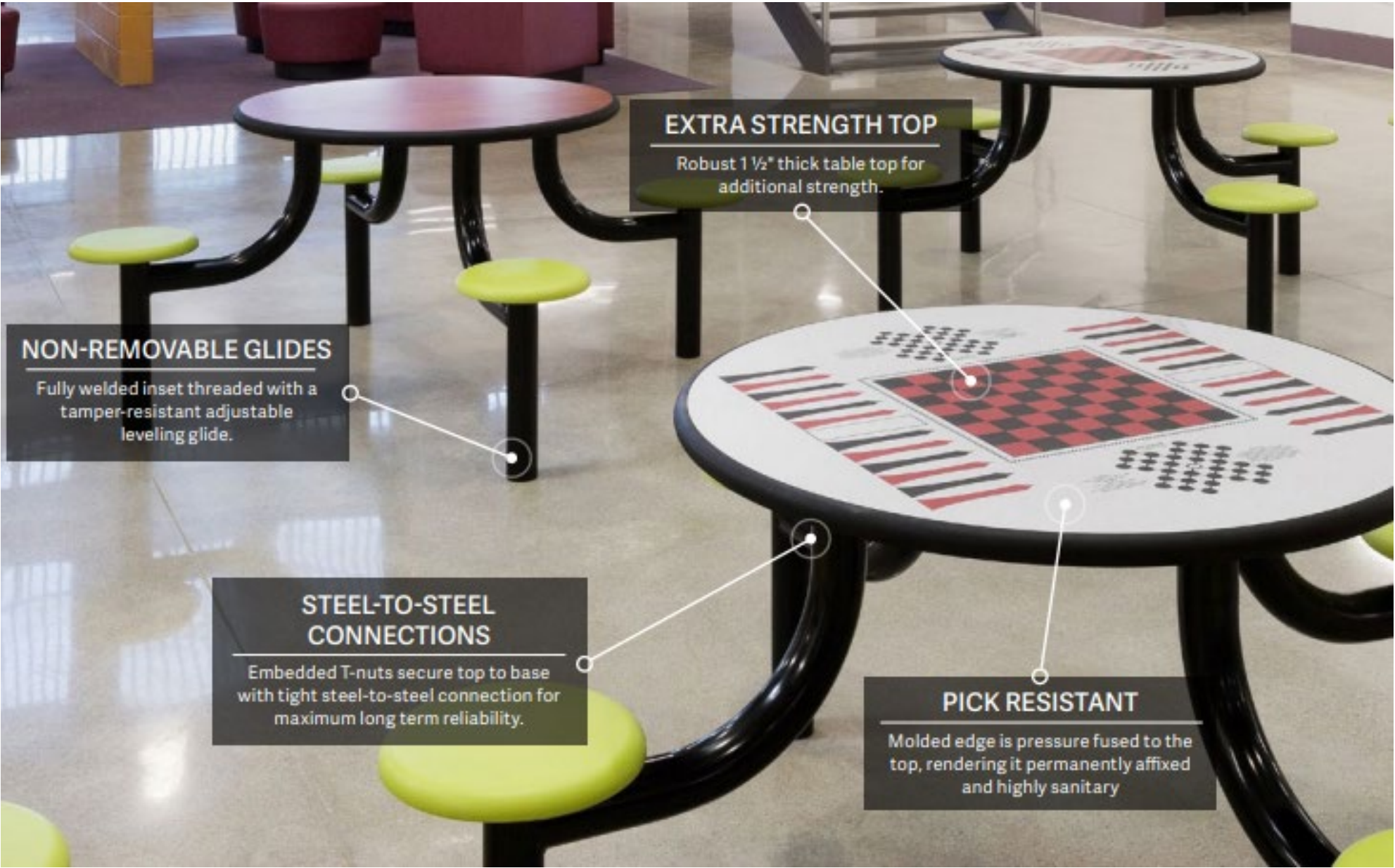

Titanium Evolve
Game Top



Raven



Lagoon



CAFÉ TABLES (QTY 2)

- Norix Max-Master
- 42" Round
- Bolt-Down Kit
- Top: Titanium Evolve Game Top
- Base: Raven
- Seats: Lagoon



STUDENT CHAIRS

- Haworth Maari
- Armless
- Plastic Glides
- Sled Base: Black
- Poly Shell: Indigo



Indigo
TR-1V



Black
TR-F



TEACHER CHAIRS

- AIS Bolton
- Mid-back
- 4D Arms
- Center Tension Synchro-Tilt Mechanism
- Seat Depth Adjustment
- Plastic Base on Hard Casters
- Mesh Back: Solid Black
- Fabric Seat: Black
- Base/Frame: Black



Proposal

Sold To: Lake County Juvenile Depke
24647 N. Milwaukee Ave
Vernon Hills, IL 60061

ATTN: Dennis McMahan
Phone: 847-377-7989

Install At: Lake County Juvenile Depke
24647 N. Milwaukee Ave
Vernon Hills, IL 60061

ATTN: Dennis McMahan
Phone: 847-377-7989

Quote #: 44199

Date: 01/10/2022

Customer PO #:

Salesperson: Julie Kominsky

Terms: 50% NET 30

DEPKES CLASSROOMS

Group				Extended
01 Classroom 1219				\$24,756.32
Line	Qty	Product	Unit	Extended
3	2.00	Primary Carrel Starter 36w 30d 48h; Worksurface is 24"D & Panels Extend Past Work Surface 6" TOP INSET MATERIAL:PLASTIC LAMINATE TOP EDGE TYPE:3MM PVC TOP EDGE MATERIAL:CHARTER IND MATCHING PVC TABLE LAM MATERIAL:WILSONART MONTICELLO MAPLE 7925-38 BASE MATERIAL:LAMINATE DIVIDER MATERIAL:WILSONART MONTICELLO MAPLE 7925-38 DIVIDER PANEL EDGE:3MM PVC DIVIDER EDGE MATERIAL:CHARTER IND MATCHING PVC	\$1,724.07	\$3,448.14
4	8.00	Primary Carrel Adder 35w 30d 48h; Worksurface is 24"D & Panels Extend Past Work Surface 6" TOP INSET MATERIAL:PLASTIC LAMINATE TOP EDGE TYPE:3MM PVC TOP EDGE MATERIAL:CHARTER IND MATCHING PVC TABLE LAM MATERIAL:WILSONART MONTICELLO MAPLE 7925-38 BASE MATERIAL:LAMINATE DIVIDER MATERIAL:WILSONART MONTICELLO MAPLE 7925-38 DIVIDER PANEL EDGE:3MM PVC DIVIDER EDGE MATERIAL:CHARTER IND MATCHING PVC	\$1,496.67	\$11,973.36
5	10.00	Dean In-surface mounted power unit w/72" cord (1) outlet & (1) 2-port USB, Black)	\$237.93	\$2,379.30
6	10.00	Half Shell Wire Tray Top Mount in Black	\$55.26	\$552.60
7	10.00	4-Trak Power System- 1 Duplex-2 Power	\$113.24	\$1,132.40
8	1.00	CB LH Curved Corner Desk Shell Full Mod Recessed 30Dx72Wx42Wx24Dx29h EDGE:2mm Grade A	\$736.03	\$736.03

		RO-E029-V2:EDGE DETAIL 2MM BLACK RIGID SMOOTH EDGE:2mm T-Mold Edge - Grade A - Curved Edging RO-E129:2MM T-Mold - Black RW-GRCB:B - Rear Center - Location 1 (Default) GROMMETC:Grommet Cover Color Selection W-GRC3B:Grommet Cover - Black LAMAISA:AIS GRADE B LAMINATES LAMAISAW:AIS GRADE B WOODGRAIN LAMINATES RO-L0168:Laminate - Monticello Maple - (B-H-W-W-7925-		
9	1.00	Rectangular - 2mm Edge - 24D x 36W EDGE:2mm Grade A RO-E029-V2:EDGE DETAIL 2MM BLACK RIGID SMOOTH RW-GRRC:C - Location 2 GROMMETC:Grommet Cover Color Selection W-GRC3B:Grommet Cover - Black LAMAISA:AIS GRADE B LAMINATES LAMAISAW:AIS GRADE B WOODGRAIN LAMINATES RO-L0168:Laminate - Monticello Maple - (B-H-W-W-7925-	\$139.40	\$139.40
10	3.00	Flat Plate	\$8.67	\$26.01
11	1.00	FLSP F - Female 1 End - 12D EDGE:2mm Grade A RO-E029-V2:EDGE DETAIL 2MM BLACK RIGID SMOOTH LAMAISA:AIS GRADE B LAMINATES LAMAISAW:AIS GRADE B WOODGRAIN LAMINATES RO-L0168:Laminate - Monticello Maple - (B-H-W-W-7925-	\$120.73	\$120.73
12	1.00	FLSP A - Male 1 End Flush - 24D EDGE:2mm Grade A RO-E029-V2:EDGE DETAIL 2MM BLACK RIGID SMOOTH LAMAISA:AIS GRADE B LAMINATES LAMAISAW:AIS GRADE B WOODGRAIN LAMINATES RO-L0168:Laminate - Monticello Maple - (B-H-W-W-7925-	\$153.74	\$153.74
13	1.00	"Pedestal Box/Box/File Mobile Lseries Laminated 24""D" PAINTMXP7:Paint Choice for Pedestals PAINTHAP2-15:Grade A Paint - Mobile Pedestals R0-P0002:BK-Black EDGE:2mm Grade A RO-E029-V2:EDGE DETAIL 2MM BLACK RIGID SMOOTH LAMAISA:AIS GRADE B LAMINATES LAMAISAW:AIS GRADE B WOODGRAIN LAMINATES RO-L0168:Laminate - Monticello Maple - (B-H-W-W-7925-	\$460.90	\$460.90
14	1.00	Mobile Pedestal - File,File - 24D - Lam Front PAINTMXP7:Paint Choice for Pedestals PAINTHAP2-15:Grade A Paint - Mobile Pedestals R0-P0002:BK-Black EDGE:2mm Grade A RO-E029-V2:EDGE DETAIL 2MM BLACK RIGID SMOOTH LAMAISA:AIS GRADE B LAMINATES LAMAISAW:AIS GRADE B WOODGRAIN LAMINATES	\$460.90	\$460.90

RO-L0168:Laminate - Monticello Maple - (B-H-W-W-7925-

15	5.00	HANDLE L PULL PAINTED BLACK	\$7.34	\$36.70
16	1.00	Key Alike Kit (2 Cores) - Wesko Type	\$8.67	\$8.67
17	1.00	Core Removal Key - Wesko Type	\$4.00	\$4.00
18	1.00	Tbl, Sqr, 2mm, 24dx29h, Stlx24, Gld EDGE:2mm Grade A RO-E029-V2:EDGE DETAIL 2MM BLACK RIGID SMOOTH LAMTABB:TABLES GRADE B LAMINATES LAMAISA:AIS GRADE B LAMINATES LAMAISAW:AIS GRADE B WOODGRAIN LAMINATES RO-L0168:Laminate - Monticello Maple - (B-H-W-W-7925- PAINTSB-A001:Grade A Paint For Steel Bases RO-P0002:BK - Black	\$234.45	\$234.45
19	1.00	Surface Works Extol Flip-Top Table; 42" X 42"; EB Edge; Locking Casters LAMINATE TOP:MONTICELLO MAPLE EDGE FINISH:MONTICELLO MAPLE BASE FINISH:BLACK	\$436.24	\$436.24
20	1.00	Bolton Black Mid Back Configurable CP-CHAIR-ASSY:ASSEMBLED CP-4471-BMBACK:BLACK FRAME/BLACK SOLID MESH BACK STANDARD CP-4DARM:BLACK 4D ARM - PAIR CP-BASEB:CHAIR BASE - BLACK CP-60MMHARD:HARD CASTERS FOR CARPET STANDARD - SET OF 5 CP-3CYLINDER:4" CYLINDER - STANDARD CP-NONE:CAL 117 STANDARD CP-MECHSLS:MECHANISM CENTER TENSION SYNCHRO WITH SEAT S CP-49SEATBLACK:BLACK UPHOLSTERY STANDARD	\$427.49	\$427.49
21	1.00	Bolton Lumbar Support	\$23.46	\$23.46
22	10.00	Maari Sled Base, Poly Seat, Poly Back, No Arm, Plastic Glide Seat 1 Color:,TR-1V:INDIGO GRD A Frame Color:,TR-F:BLACK GRD A	\$200.18	\$2,001.80

Group				Extended
02 Classroom 1220				\$24,225.19
Line	Qty	Product	Unit	Extended
23	3.00	Primary Carrel Starter 36w 30d 48h; Worksurface is 24"D & Panels Extend Past Work Surface 6" TOP INSET MATERIAL:PLASTIC LAMINATE TOP EDGE TYPE:3MM PVC	\$1,724.07	\$5,172.21

TOP EDGE MATERIAL:CHARTER IND MATCHING PVC
 TABLE LAM MATERIAL:WILSONART MONTICELLO MAPLE 7925-38
 BASE MATERIAL:LAMINATE
 DIVIDER MATERIAL:WILSONART MONTICELLO MAPLE 7925-38
 DIVIDER PANEL EDGE:3MM PVC
 DIVIDER EDGE MATERIAL:CHARTER IND MATCHING PVC

24	6.00	Primary Carrel Adder 35w 30d 48h; Worksurface is 24"D & Panels Extend Past Work Surface 6" TOP INSET MATERIAL:PLASTIC LAMINATE TOP EDGE TYPE:3MM PVC TOP EDGE MATERIAL:CHARTER IND MATCHING PVC TABLE LAM MATERIAL:WILSONART MONTICELLO MAPLE 7925-38 BASE MATERIAL:LAMINATE DIVIDER MATERIAL:WILSONART MONTICELLO MAPLE 7925-38 DIVIDER PANEL EDGE:3MM PVC DIVIDER EDGE MATERIAL:CHARTER IND MATCHING PVC	\$1,496.67	\$8,980.02
25	9.00	Dean In-surface mounted power unit w/72" cord (1) outlet & (1) 2-port USB, Black)	\$237.93	\$2,141.37
26	9.00	Half Shell Wire Tray Top Mount in Black	\$55.26	\$497.34
27	7.00	4-Trak Power System- 1 Duplex-2 Power	\$113.24	\$792.68
28	1.00	TBL, REC, 2mm, 24Dx48Wx29H, HAL, GLD V2 EDGE:2MM GRADE A RO-E029-V2:EDGE DETAIL 2MM BLACK RIGID SMOOTH RW-GRRA:OPTION A - NO ADDITIONAL GROMMETS LAMTABB:TABLES GRADE B LAMINATES LAMAISA:AIS GRADE B LAMINATES LAMAISAW:AIS GRADE B WOODGRAIN LAMINATES RO-L0168:LAMINATE - MONTICELLO MAPLE - (B-H-W-W-7925- RWFS-3S2L24-B:HAT BASE, 3 SEG, 50X80, 2 LEG, 24D, BLACK	\$884.78	\$884.78
29	1.00	Byrne Dean In Surface Power Module; 1 Power/1 USB Charger; 72" Cord FINISH:BLACK	\$158.84	\$158.84
30	1.00	Slimline Scrn,Frnt-Rr,FVWL,Dim Mnt,Uni,16hx48w PAINTOXA-15:OXYGEN GRADE A PAINT SELECTION RO-P0002:BK - BLACK OX-LIWM1648:SCREEN LAMINATE INSERT A WRAP MOUNT LAMINATEBI:LAMINATE GRADE B LWGRAINBI:GRADE B WOODGRAIN LAMINATES LAMINATEBW:WOODGRAIN LAMINATE OPTION - GRADE B LWILSONARTBW:WILSONART GRADE B WOODGRAIN LAMINATES RO-L0168:LAMINATE - MONTICELLO MAPLE - (B-H-W-W-7925- OX-LIWM1648B:SCREEN LAMINATE INSERT B WRAP MOUNT 16 X 48 LAMINATEBI:LAMINATE GRADE B LWGRAINBI:GRADE B WOODGRAIN LAMINATES LAMINATEBW:WOODGRAIN LAMINATE OPTION - GRADE B LWILSONARTBW:WILSONART GRADE B WOODGRAIN LAMINATES RO-L0168:LAMINATE - MONTICELLO MAPLE - (B-H-W-W-7925-	\$198.77	\$198.77

31	1.00	Slimline Scrn,Terri,FVWL,Dim A,UMnt,LH,16hx24w PAINTOXA-15:OXYGEN GRADE A PAINT SELECTION RO-P0002:BK - BLACK OX-LIWM1648:SCREEN LAMINATE INSERT A WRAP MOUNT LAMINATEBI:LAMINATE GRADE B LWGRAINBI:GRADE B WOODGRAIN LAMINATES LAMINATEBW:WOODGRAIN LAMINATE OPTION - GRADE B LWILSONARTBW:WILSONART GRADE B WOODGRAIN LAMINATES RO-L0168:LAMINATE - MONTICELLO MAPLE - (B-H-W-W-7925- OX-LIWM1648B:SCREEN LAMINATE INSERT B WRAP MOUNT 16 X 48 LAMINATEBI:LAMINATE GRADE B LWGRAINBI:GRADE B WOODGRAIN LAMINATES LAMINATEBW:WOODGRAIN LAMINATE OPTION - GRADE B LWILSONARTBW:WILSONART GRADE B WOODGRAIN LAMINATES RO-L0168:LAMINATE - MONTICELLO MAPLE - (B-H-W-W-7925-	\$166.42	\$166.42
32	1.00	Slimline Scrn,Terri,FVWL,Dim,UMnt,RH,16hx24w PAINTOXA-15:Oxygen Grade A Paint Selection RO-P0002:BK - Black OX-LIWM1648:SCREEN LAMINATE INSERT A WRAP MOUNT LAMINATEBI:Laminate Grade B LWGRAINBI:Grade B Woodgrain Laminates LAMINATEBW:Woodgrain Laminate Option - Grade B LWILSONARTBW:Wilsonart Grade B Woodgrain Laminates RO-L0168:Laminate - Monticello Maple - (B-H-W-W-7925- OX-LIWM1648B:SCREEN LAMINATE INSERT B WRAP MOUNT 16 X 48 LAMINATEBI:Laminate Grade B LWGRAINBI:Grade B Woodgrain Laminates LAMINATEBW:Woodgrain Laminate Option - Grade B LWILSONARTBW:Wilsonart Grade B Woodgrain Laminates RO-L0168:Laminate - Monticello Maple - (B-H-W-W-7925-	\$166.42	\$166.42
33	1.00	CB RH Curved Corner Desk Shell Full Mod Recessed 24Dx42Wx72Wx30Dx29h EDGE:2mm Grade A RO-E029-V2:EDGE DETAIL 2MM BLACK RIGID SMOOTH EDGE:2mm T-Mold Edge - Grade A - Curved Edging RO-E129:2MM T-Mold - Black RW-GRCB:B - Rear Center - Location 1 (Default) GROMMETC:Grommet Cover Color Selection W-GRC3B:Grommet Cover - Black LAMAISA:AIS GRADE B LAMINATES LAMAISAW:AIS GRADE B WOODGRAIN LAMINATES RO-L0168:Laminate - Monticello Maple - (B-H-W-W-7925-	\$736.03	\$736.03
34	1.00	Rectangular - 2mm Edge - 24D x 36W EDGE:2mm Grade A RO-E029-V2:EDGE DETAIL 2MM BLACK RIGID SMOOTH RW-GRRD:D - Location 3 GROMMETC:Grommet Cover Color Selection W-GRC3B:Grommet Cover - Black LAMAISA:AIS GRADE B LAMINATES	\$139.40	\$139.40

LAMASAW: AIS GRADE B WOODGRAIN LAMINATES
RO-L0168: Laminate - Monticello Maple - (B-H-W-W-7925-

35	3.00	Flat Plate	\$8.67	\$26.01
36	1.00	FLSP F - Female 1 End - 12D EDGE: 2mm Grade A RO-E029-V2: EDGE DETAIL 2MM BLACK RIGID SMOOTH LAMAISA: AIS GRADE B LAMINATES LAMAISAW: AIS GRADE B WOODGRAIN LAMINATES RO-L0168: Laminate - Monticello Maple - (B-H-W-W-7925-	\$120.73	\$120.73
37	1.00	FLSP A - Male 1 End Flush - 24D EDGE: 2mm Grade A RO-E029-V2: EDGE DETAIL 2MM BLACK RIGID SMOOTH LAMAISA: AIS GRADE B LAMINATES LAMAISAW: AIS GRADE B WOODGRAIN LAMINATES RO-L0168: Laminate - Monticello Maple - (B-H-W-W-7925-	\$153.74	\$153.74
38	1.00	"Pedestal Box/Box/File Mobile Lseries Laminated 24""D" PAINTMPX7: Paint Choice for Pedestals PAINTHAP2-15: Grade A Paint - Mobile Pedestals R0-P0002: BK-Black EDGE: 2mm Grade A RO-E029-V2: EDGE DETAIL 2MM BLACK RIGID SMOOTH LAMAISA: AIS GRADE B LAMINATES LAMAISAW: AIS GRADE B WOODGRAIN LAMINATES RO-L0168: Laminate - Monticello Maple - (B-H-W-W-7925-	\$460.90	\$460.90
39	1.00	Mobile Pedestal - File, File - 24D - Lam Front PAINTMPX7: Paint Choice for Pedestals PAINTHAP2-15: Grade A Paint - Mobile Pedestals R0-P0002: BK-Black EDGE: 2mm Grade A RO-E029-V2: EDGE DETAIL 2MM BLACK RIGID SMOOTH LAMAISA: AIS GRADE B LAMINATES LAMAISAW: AIS GRADE B WOODGRAIN LAMINATES RO-L0168: Laminate - Monticello Maple - (B-H-W-W-7925-	\$460.90	\$460.90
40	5.00	HANDLE L PULL PAINTED BLACK	\$7.34	\$36.70
41	1.00	Key Alike Kit (2 Cores) - Wesko Type	\$8.67	\$8.67
42	1.00	Tbl, Sqr, 2mm, 24dx29h, Stlx24, Gld EDGE: 2mm Grade A RO-E029-V2: EDGE DETAIL 2MM BLACK RIGID SMOOTH LAMTABB: TABLES GRADE B LAMINATES LAMAISA: AIS GRADE B LAMINATES LAMAISAW: AIS GRADE B WOODGRAIN LAMINATES RO-L0168: Laminate - Monticello Maple - (B-H-W-W-7925- PAINTSB-A001: Grade A Paint For Steel Bases RO-P0002: BK - Black	\$234.45	\$234.45

43	1.00	Surface Works Extol Flip-Top Table; 42" X 42"; EB Edge; Locking Casters LAMINATE TOP:MONTICELLO MAPLE EDGE FINISH:MONTICELLO MAPLE BASE FINISH:BLACK QUOTE:QSW21_056382-2	\$436.24	\$436.24
44	1.00	Bolton Black Mid Back Configurable CP-CHAIR-ASSY:ASSEMBLED CP-4471-BMBACK:BLACK FRAME/BLACK SOLID MESH BACK STANDARD CP-4DARM:BLACK 4D ARM - PAIR CP-BASEB:CHAIR BASE - BLACK CP-60MMHARD:HARD CASTERS FOR CARPET STANDARD - SET OF 5 CP-3CYLINDER:4" CYLINDER - STANDARD CP-NONE:CAL 117 STANDARD CP-MECHSLS:MECHANISM CENTER TENSION SYNCHRO with SEAT S CP-49SEATBLACK:BLACK UPHOLSTERY STANDARD	\$427.49	\$427.49
45	1.00	Bolton Lumbar Support	\$23.46	\$23.46
46	9.00	Maari Sled Base, Poly Seat, Poly Back, No Arm, Plastic Glide Seat 1 Color:,TR-1V:INDIGO GRD A Frame Color:,TR-F:BLACK GRD A	\$200.18	\$1,801.62

Group	Extended
03 Classroom 1221	\$27,407.04

Line	Qty	Product	Unit	Extended
47	2.00	Primary Carrel Starter 36w 30d 48h; Worksurface is 24"D & Panels Extend Past Work Surface 6" TOP INSET MATERIAL:PLASTIC LAMINATE TOP EDGE TYPE:3MM PVC TOP EDGE MATERIAL:CHARTER IND MATCHING PVC TABLE LAM MATERIAL:WILSONART MONTICELLO MAPLE 7925-38 BASE MATERIAL:LAMINATE DIVIDER MATERIAL:WILSONART MONTICELLO MAPLE 7925-38 DIVIDER PANEL EDGE:3MM PVC DIVIDER EDGE MATERIAL:CHARTER IND MATCHING PVC	\$1,724.07	\$3,448.14
48	8.00	Primary Carrel Adder 35w 30d 48h; Worksurface is 24"D & Panels Extend Past Work Surface 6" TOP INSET MATERIAL:PLASTIC LAMINATE TOP EDGE TYPE:3MM PVC TOP EDGE MATERIAL:CHARTER IND MATCHING PVC TABLE LAM MATERIAL:WILSONART MONTICELLO MAPLE 7925-38 BASE MATERIAL:LAMINATE DIVIDER MATERIAL:WILSONART MONTICELLO MAPLE 7925-38 DIVIDER PANEL EDGE:3MM PVC DIVIDER EDGE MATERIAL:CHARTER IND MATCHING PVC	\$1,496.67	\$11,973.36
49	10.00	Dean In-surface mounted power unit w/72" cord (1) outlet & (1) 2-port USB,	\$237.93	\$2,379.30

Black)

50	10.00	Half Shell Wire Tray Top Mount in Black	\$55.26	\$552.60
51	10.00	4-Trak Power System- 1 Duplex-2 Power	\$113.24	\$1,132.40
52	1.00	TBL, REC, 2mm, 24Dx48Wx29H, HAL, GLD V2 EDGE:2MM GRADE A RO-E029-V2:EDGE DETAIL 2MM BLACK RIGID SMOOTH RW-GRR:OPTION A - NO ADDITIONAL GROMMETS LAMTABB:TABLES GRADE B LAMINATES LAMAISA:AIS GRADE B LAMINATES LAMAISAW:AIS GRADE B WOODGRAIN LAMINATES RO-L0168:LAMINATE - MONTICELLO MAPLE - (B-H-W-W-7925- RWFS-3S2L24-B:HAT BASE, 3 SEG, 50X80, 2 LEG, 24D, BLACK	\$884.78	\$884.78
53	1.00	Byrne Dean In Surface Power Module; 1 Power/1 USB Charger; 72" Cord FINISH:BLACK	\$158.84	\$158.84
54	1.00	Slimline Scrn,Frnt-Rr,FVWL,Dim G Mnt,Uni,16hx48w PAINTOX-15:OXYGEN GRADE A PAINT SELECTION RO-P0002:BK - BLACK OX-LIWM1648:SCREEN LAMINATE INSERT A WRAP MOUNT LAMINATEBI:LAMINATE GRADE B LWGRAINBI:GRADE B WOODGRAIN LAMINATES LAMINATEBW:WOODGRAIN LAMINATE OPTION - GRADE B LWILSONARTBW:WILSONART GRADE B WOODGRAIN LAMINATES RO-L0168:LAMINATE - MONTICELLO MAPLE - (B-H-W-W-7925- OX-LIWM1648B:SCREEN LAMINATE INSERT B WRAP MOUNT 16 X 48 LAMINATEBI:LAMINATE GRADE B LWGRAINBI:GRADE B WOODGRAIN LAMINATES LAMINATEBW:WOODGRAIN LAMINATE OPTION - GRADE B LWILSONARTBW:WILSONART GRADE B WOODGRAIN LAMINATES RO-L0168:LAMINATE - MONTICELLO MAPLE - (B-H-W-W-7925-	\$198.77	\$198.77
55	1.00	Slimline Scrn,Terri,FVWL,Dim D,UMnt,LH,16hx24w PAINTOX-15:OXYGEN GRADE A PAINT SELECTION RO-P0002:BK - BLACK OX-LIWM1648:SCREEN LAMINATE INSERT A WRAP MOUNT LAMINATEBI:LAMINATE GRADE B LWGRAINBI:GRADE B WOODGRAIN LAMINATES LAMINATEBW:WOODGRAIN LAMINATE OPTION - GRADE B LWILSONARTBW:WILSONART GRADE B WOODGRAIN LAMINATES RO-L0168:LAMINATE - MONTICELLO MAPLE - (B-H-W-W-7925- OX-LIWM1648B:SCREEN LAMINATE INSERT B WRAP MOUNT 16 X 48 LAMINATEBI:LAMINATE GRADE B LWGRAINBI:GRADE B WOODGRAIN LAMINATES LAMINATEBW:WOODGRAIN LAMINATE OPTION - GRADE B LWILSONARTBW:WILSONART GRADE B WOODGRAIN LAMINATES RO-L0168:LAMINATE - MONTICELLO MAPLE - (B-H-W-W-7925-	\$166.42	\$166.42
56	1.00	Slimline Scrn,Terri,FVWL,Dim D,UMnt,RH,16hx24w	\$166.42	\$166.42

PAINTOXA-15:OXYGEN GRADE A PAINT SELECTION
 RO-P0002:BK - BLACK
 OX-LIWM1648:SCREEN LAMINATE INSERT A WRAP MOUNT
 LAMINATEBI:LAMINATE GRADE B
 LWGRAINBI:GRADE B WOODGRAIN LAMINATES
 LAMINATEBW:WOODGRAIN LAMINATE OPTION - GRADE B
 LWILSONARTBW:WILSONART GRADE B WOODGRAIN LAMINATES
 RO-L0168:LAMINATE - MONTICELLO MAPLE - (B-H-W-W-7925-
 OX-LIWM1648B:SCREEN LAMINATE INSERT B WRAP MOUNT 16 X

48

LAMINATEBI:LAMINATE GRADE B
 LWGRAINBI:GRADE B WOODGRAIN LAMINATES
 LAMINATEBW:WOODGRAIN LAMINATE OPTION - GRADE B
 LWILSONARTBW:WILSONART GRADE B WOODGRAIN LAMINATES
 RO-L0168:LAMINATE - MONTICELLO MAPLE - (B-H-W-W-7925-

57	1.00	CB RH Curved Corner Desk Shell Full Mod Recessed 24Dx42Wx72Wx30Dx29h EDGE:2mm Grade A RO-E029-V2:EDGE DETAIL 2MM BLACK RIGID SMOOTH EDGE:2mm T-Mold Edge - Grade A - Curved Edging RO-E129:2MM T-Mold - Black RW-GRCB:B - Rear Center - Location 1 (Default) GROMMETC:Grommet Cover Color Selection W-GRC3B:Grommet Cover - Black LAMAIISA:AIS GRADE B LAMINATES LAMAIASAW:AIS GRADE B WOODGRAIN LAMINATES RO-L0168:Laminates - Monticello Maple - (B-H-W-W-7925-	\$736.03	\$736.03
58	1.00	Rectangular - 2mm Edge - 24D x 36W EDGE:2MM GRADE A RO-E029-V2:EDGE DETAIL 2MM BLACK RIGID SMOOTH RW-GRRD:D - LOCATION 3 GROMMETC:GROMMET COVER COLOR SELECTION W-GRC3B:GROMMET COVER - BLACK LAMAIISA:AIS GRADE B LAMINATES LAMAIASAW:AIS GRADE B WOODGRAIN LAMINATES RO-L0168:LAMINATE - MONTICELLO MAPLE - (B-H-W-W-7925-	\$139.40	\$139.40
59	3.00	Flat Plate	\$8.67	\$26.01
60	1.00	FLSP F - Female 1 End - 12D EDGE:2MM GRADE A RO-E029-V2:EDGE DETAIL 2MM BLACK RIGID SMOOTH LAMAIISA:AIS GRADE B LAMINATES LAMAIASAW:AIS GRADE B WOODGRAIN LAMINATES RO-L0168:LAMINATE - MONTICELLO MAPLE - (B-H-W-W-7925-	\$120.73	\$120.73
61	1.00	FLSP A - Male 1 End Flush - 24D EDGE:2MM GRADE A RO-E029-V2:EDGE DETAIL 2MM BLACK RIGID SMOOTH LAMAIISA:AIS GRADE B LAMINATES LAMAIASAW:AIS GRADE B WOODGRAIN LAMINATES RO-L0168:LAMINATE - MONTICELLO MAPLE - (B-H-W-W-7925-	\$153.74	\$153.74

62	1.00	"Pedestal Box/Box/File Mobile Lseries Laminated 24""D" PAINTMXP7:Paint Choice for Pedestals PAINTHAP2-15:Grade A Paint - Mobile Pedestals R0-P0002:BK-Black EDGE:2mm Grade A RO-E029-V2:EDGE DETAIL 2MM BLACK RIGID SMOOTH LAMAISA:AIS GRADE B LAMINATES LAMAISAW:AIS GRADE B WOODGRAIN LAMINATES RO-L0168:Laminate - Monticello Maple - (B-H-W-W-7925-	\$460.90	\$460.90
63	1.00	Mobile Pedestal - File,File - 24D - Lam Front PAINTMXP7:Paint Choice for Pedestals PAINTHAP2-15:Grade A Paint - Mobile Pedestals R0-P0002:BK-Black EDGE:2mm Grade A RO-E029-V2:EDGE DETAIL 2MM BLACK RIGID SMOOTH LAMAISA:AIS GRADE B LAMINATES LAMAISAW:AIS GRADE B WOODGRAIN LAMINATES RO-L0168:Laminate - Monticello Maple - (B-H-W-W-7925-	\$460.90	\$460.90
64	5.00	HANDLE L PULL PAINTED BLACK	\$7.34	\$36.70
65	1.00	Key Alike Kit (2 Cores) - Wesko Type	\$8.67	\$8.67
66	1.00	Lateral File L Series Sq. Front 4 Drawer 36 in. PAINTHA-15:Paint Grade A RO-P0002:BK - Black	\$883.11	\$883.11
67	1.00	Key Alike Kit (1 Core) - Wesko Type	\$5.34	\$5.34
68	1.00	26.56"d x 15.15"w x 64.25"h, 5 Drawer - Letter Size, Lock, 2600 SERIES, UNIVERSAL FILING ~STD:Metal File Case & Storage Front Paint Finish ~GLO:Global Standard Colors BLK:2-Black W401:C-Keyed For Lock #W401 ~:Interlock Mech Not Required	\$425.49	\$425.49
69	1.00	Surface Works Extol Flip-Top Table; 42" X 42"; EB Edge; Locking Casters LAMINATE TOP:MONTICELLO MAPLE EDGE FINISH:MONTICELLO MAPLE BASE FINISH:BLACK	\$436.24	\$436.24
70	1.00	Bolton Black Mid Back Configurable CP-CHAIR-ASSY:ASSEMBLED CP-4471-BMBACK:BLACK FRAME/BLACK SOLID MESH BACK STANDARD CP-4DARM:BLACK 4D ARM - PAIR CP-BASEB:CHAIR BASE - BLACK CP-60MMHARD:HARD CASTERS FOR CARPET STANDARD - SET OF 5 CP-3CYLINDER:4" CYLINDER - STANDARD CP-NONE:CAL 117 STANDARD	\$427.49	\$427.49

CP-MECHSLS:MECHANISM CENTER TENSION SYNCHRO WITH
SEAT S
CP-49SEATBLACK:BLACK UPHOLSTERY STANDARD

71	1.00	Bolton Lumbar Support	\$23.46	\$23.46
72	10.00	Maari Sled Base, Poly Seat, Poly Back, No Arm, Plastic Glide Seat 1 Color:,TR-1V:INDIGO GRD A Frame Color:,TR-F:BLACK GRD A	\$200.18	\$2,001.80

Group	Extended
04 Classroom 1227	\$24,979.72

Line	Qty	Product	Unit	Extended
73	3.00	Primary Carrel Starter 36w 30d 48h; Worksurface is 24"D & Panels Extend Past Work Surface 6" TOP INSET MATERIAL:PLASTIC LAMINATE TOP EDGE TYPE:3MM PVC TOP EDGE MATERIAL:CHARTER IND MATCHING PVC TABLE LAM MATERIAL:WILSONART MONTICELLO MAPLE 7925-38 BASE MATERIAL:LAMINATE DIVIDER MATERIAL:WILSONART MONTICELLO MAPLE 7925-38 DIVIDER PANEL EDGE:3MM PVC DIVIDER EDGE MATERIAL:CHARTER IND MATCHING PVC	\$1,724.07	\$5,172.21
74	7.00	Primary Carrel Adder 35w 30d 48h; Worksurface is 24"D & Panels Extend Past Work Surface 6" TOP INSET MATERIAL:PLASTIC LAMINATE TOP EDGE TYPE:3MM PVC TOP EDGE MATERIAL:CHARTER IND MATCHING PVC TABLE LAM MATERIAL:WILSONART MONTICELLO MAPLE 7925-38 BASE MATERIAL:LAMINATE DIVIDER MATERIAL:WILSONART MONTICELLO MAPLE 7925-38 DIVIDER PANEL EDGE:3MM PVC DIVIDER EDGE MATERIAL:CHARTER IND MATCHING PVC	\$1,496.67	\$10,476.69
75	10.00	Dean In-surface mounted power unit w/72" cord (1) outlet & (1) 2-port USB, Black)	\$237.93	\$2,379.30
76	10.00	Half Shell Wire Tray Top Mount in Black	\$55.26	\$552.60
77	10.00	4-Trak Power System- 1 Duplex-2 Power	\$113.24	\$1,132.40
78	1.00	Tbl, Sqr, 2mm, 24dx29h, Stlx24, Gld EDGE:2MM GRADE A RO-E029-V2:EDGE DETAIL 2MM BLACK RIGID SMOOTH LAMTABB:TABLES GRADE B LAMINATES LAMAISA:AIS GRADE B LAMINATES LAMAISAW:AIS GRADE B WOODGRAIN LAMINATES RO-L0168:LAMINATE - MONTICELLO MAPLE - (B-H-W-W-7925- PAINTSB-A001:GRADE A PAINT FOR STEEL BASES RO-P0002:BK - BLACK	\$234.45	\$234.45

79	1.00	CB LH Curved Corner Desk Shell Full Mod Recessed 30Dx72Wx42Wx24Dx29h EDGE:2MM GRADE A RO-E029-V2:EDGE DETAIL 2MM BLACK RIGID SMOOTH EDGE:2MM T-MOLD EDGE - GRADE A - CURVED EDGING RO-E129:2MM T-MOLD - BLACK RW-GRCB:B - REAR CENTER - LOCATION 1 (DEFAULT) GROMMETC:GROMMET COVER COLOR SELECTION W-GRC3B:GROMMET COVER - BLACK LAMAISA:AIS GRADE B LAMINATES LAMAISAW:AIS GRADE B WOODGRAIN LAMINATES RO-L0168:LAMINATE - MONTICELLO MAPLE - (B-H-W-W-7925-	\$736.03	\$736.03
80	1.00	Rectangular - 2mm Edge - 24D x 36W EDGE:2MM GRADE A RO-E029-V2:EDGE DETAIL 2MM BLACK RIGID SMOOTH RW-GRRC:C - LOCATION 2 GROMMETC:GROMMET COVER COLOR SELECTION W-GRC3B:GROMMET COVER - BLACK LAMAISA:AIS GRADE B LAMINATES LAMAISAW:AIS GRADE B WOODGRAIN LAMINATES RO-L0168:LAMINATE - MONTICELLO MAPLE - (B-H-W-W-7925-	\$139.40	\$139.40
81	3.00	Flat Plate	\$8.67	\$26.01
82	1.00	FLSP F - Female 1 End - 12D EDGE:2MM GRADE A RO-E029-V2:EDGE DETAIL 2MM BLACK RIGID SMOOTH LAMAISA:AIS GRADE B LAMINATES LAMAISAW:AIS GRADE B WOODGRAIN LAMINATES RO-L0168:LAMINATE - MONTICELLO MAPLE - (B-H-W-W-7925-	\$120.73	\$120.73
83	1.00	FLSP A - Male 1 End Flush - 24D EDGE:2MM GRADE A RO-E029-V2:EDGE DETAIL 2MM BLACK RIGID SMOOTH LAMAISA:AIS GRADE B LAMINATES LAMAISAW:AIS GRADE B WOODGRAIN LAMINATES RO-L0168:LAMINATE - MONTICELLO MAPLE - (B-H-W-W-7925-	\$153.74	\$153.74
84	1.00	"Pedestal Box/Box/File Mobile Lseries Laminated 24""D" PAINTMXP7:Paint Choice for Pedestals PAINTHAP2-15:Grade A Paint - Mobile Pedestals R0-P0002:BK-Black EDGE:2mm Grade A RO-E029-V2:EDGE DETAIL 2MM BLACK RIGID SMOOTH LAMAISA:AIS GRADE B LAMINATES LAMAISAW:AIS GRADE B WOODGRAIN LAMINATES RO-L0168:Laminated - Monticello Maple - (B-H-W-W-7925-	\$460.90	\$460.90
85	1.00	Mobile Pedestal - File,File - 24D - Lam Front PAINTMXP7:Paint Choice for Pedestals PAINTHAP2-15:Grade A Paint - Mobile Pedestals R0-P0002:BK-Black	\$460.90	\$460.90

EDGE:2mm Grade A
RO-E029-V2:EDGE DETAIL 2MM BLACK RIGID SMOOTH
LAMAISA:AIS GRADE B LAMINATES
LAMAISAW:AIS GRADE B WOODGRAIN LAMINATES
RO-L0168:Laminate - Monticello Maple - (B-H-W-W-7925-

86	5.00	HANDLE L PULL PAINTED BLACK	\$7.34	\$36.70
87	1.00	Key Alike Kit (2 Cores) - Wesko Type	\$8.67	\$8.67
88	1.00	Surface Works Extol Flip-Top Table; 42" X 42"; EB Edge; Locking Casters LAMINATE TOP:MONTICELLO MAPLE EDGE FINISH:MONTICELLO MAPLE BASE FINISH:BLACK	\$436.24	\$436.24
89	1.00	Bolton Black Mid Back Configurable CP-CHAIR-ASSY:ASSEMBLED CP-4471-BMBACK:BLACK FRAME/BLACK SOLID MESH BACK STANDARD CP-4DARM:BLACK 4D ARM - PAIR CP-BASEB:CHAIR BASE - BLACK CP-60MMHARD:HARD CASTERS FOR CARPET STANDARD - SET OF 5 CP-3CYLINDER:4" CYLINDER - STANDARD CP-NONE:CAL 117 STANDARD CP-MECHSLS:MECHANISM CENTER TENSION SYNCHRO WITH SEAT S CP-49SEATBLACK:BLACK UPHOLSTERY STANDARD	\$427.49	\$427.49
90	1.00	Bolton Lumbar Support	\$23.46	\$23.46
91	10.00	Maari Sled Base, Poly Seat, Poly Back, No Arm, Plastic Glide Seat 1 Color:,TR-1V:INDIGO GRD A Frame Color:,TR-F:BLACK GRD A	\$200.18	\$2,001.80

Group	Extended
05 Classroom 1705	\$29,139.68

Line	Qty	Product	Unit	Extended
92	2.00	Primary Carrel Starter 36w 30d 48h; Worksurface is 24"D & Panels Extend Past Work Surface 6" TOP INSET MATERIAL:PLASTIC LAMINATE TOP EDGE TYPE:3MM PVC TOP EDGE MATERIAL:CHARTER IND MATCHING PVC TABLE LAM MATERIAL:WILSONART MONTICELLO MAPLE 7925-38 BASE MATERIAL:LAMINATE DIVIDER MATERIAL:WILSONART MONTICELLO MAPLE 7925-38 DIVIDER PANEL EDGE:3MM PVC DIVIDER EDGE MATERIAL:CHARTER IND MATCHING PVC	\$1,724.07	\$3,448.14
93	9.00	Primary Carrel Adder 35w 30d 48h; Worksurface is 24"D & Panels Extend Past Work Surface 6"	\$1,496.67	\$13,470.03

TOP INSET MATERIAL:PLASTIC LAMINATE
 TOP EDGE TYPE:3MM PVC
 TOP EDGE MATERIAL:CHARTER IND MATCHING PVC
 TABLE LAM MATERIAL:WILSONART MONTICELLO MAPLE 7925-38
 BASE MATERIAL:LAMINATE
 DIVIDER MATERIAL:WILSONART MONTICELLO MAPLE 7925-38
 DIVIDER PANEL EDGE:3MM PVC
 DIVIDER EDGE MATERIAL:CHARTER IND MATCHING PVC

94	11.00	Dean In-surface mounted power unit w/72" cord (1) outlet & (1) 2-port USB, Black)	\$237.93	\$2,617.23
95	11.00	Half Shell Wire Tray Top Mount in Black	\$55.26	\$607.86
96	11.00	4-Trak Power System- 1 Duplex-2 Power	\$113.24	\$1,245.64
97	1.00	TBL, REC, 2mm, 24Dx48Wx29H, HAL, GLD V2 EDGE:2MM GRADE A RO-E029-V2:EDGE DETAIL 2MM BLACK RIGID SMOOTH RW-GRRR:OPTION A - NO ADDITIONAL GROMMETS LAMTABB:TABLES GRADE B LAMINATES LAMAISA:AIS GRADE B LAMINATES LAMAISAW:AIS GRADE B WOODGRAIN LAMINATES RO-L0168:LAMINATE - MONTICELLO MAPLE - (B-H-W-W-7925- RWFS-3S2L24-B:HAT BASE, 3 SEG, 50X80, 2 LEG, 24D, BLACK	\$884.78	\$884.78
98	1.00	Byrne Dean In Surface Power Module; 1 Power/1 USB Charger; 72" Cord FINISH:BLACK	\$163.61	\$163.61
99	1.00	Slimline Scrn,Frnt-Rr,FVWL,Dim G Mnt,Uni,16hx48w PAINTOXA-15:OXYGEN GRADE A PAINT SELECTION RO-P0002:BK - BLACK OX-LIWM1648:SCREEN LAMINATE INSERT A WRAP MOUNT LAMINATEBI:LAMINATE GRADE B LWGRAINBI:GRADE B WOODGRAIN LAMINATES LAMINATEBW:WOODGRAIN LAMINATE OPTION - GRADE B LWILSONARTBW:WILSONART GRADE B WOODGRAIN LAMINATES RO-L0168:LAMINATE - MONTICELLO MAPLE - (B-H-W-W-7925- OX-LIWM1648B:SCREEN LAMINATE INSERT B WRAP MOUNT 16 X 48 LAMINATEBI:LAMINATE GRADE B LWGRAINBI:GRADE B WOODGRAIN LAMINATES LAMINATEBW:WOODGRAIN LAMINATE OPTION - GRADE B LWILSONARTBW:WILSONART GRADE B WOODGRAIN LAMINATES RO-L0168:LAMINATE - MONTICELLO MAPLE - (B-H-W-W-7925-	\$198.77	\$198.77
100	1.00	Slimline Scrn,Terri,FVWL,Dim D,UMnt,LH,16hx24w PAINTOXA-15:OXYGEN GRADE A PAINT SELECTION RO-P0002:BK - BLACK OX-LIWM1648:SCREEN LAMINATE INSERT A WRAP MOUNT LAMINATEBI:LAMINATE GRADE B LWGRAINBI:GRADE B WOODGRAIN LAMINATES LAMINATEBW:WOODGRAIN LAMINATE OPTION - GRADE B LWILSONARTBW:WILSONART GRADE B WOODGRAIN LAMINATES	\$166.42	\$166.42

		RO-L0168:LAMINATE - MONTICELLO MAPLE - (B-H-W-W-7925- OX-LIWM1648B:SCREEN LAMINATE INSERT B WRAP MOUNT 16 X		
	48	LAMINATEBI:LAMINATE GRADE B LWGRAINBI:GRADE B WOODGRAIN LAMINATES LAMINATEBW:WOODGRAIN LAMINATE OPTION - GRADE B LWILSONARTBW:WILSONART GRADE B WOODGRAIN LAMINATES RO-L0168:LAMINATE - MONTICELLO MAPLE - (B-H-W-W-7925-		
101	1.00	Slimline Scrn,Terri,FVWL,Dim D,UMnt,RH,16hx24w PAINTOXA-15:OXYGEN GRADE A PAINT SELECTION RO-P0002:BK - BLACK OX-LIWM1648:SCREEN LAMINATE INSERT A WRAP MOUNT LAMINATEBI:LAMINATE GRADE B LWGRAINBI:GRADE B WOODGRAIN LAMINATES LAMINATEBW:WOODGRAIN LAMINATE OPTION - GRADE B LWILSONARTBW:WILSONART GRADE B WOODGRAIN LAMINATES RO-L0168:LAMINATE - MONTICELLO MAPLE - (B-H-W-W-7925- OX-LIWM1648B:SCREEN LAMINATE INSERT B WRAP MOUNT 16 X	\$166.42	\$166.42
	48	LAMINATEBI:LAMINATE GRADE B LWGRAINBI:GRADE B WOODGRAIN LAMINATES LAMINATEBW:WOODGRAIN LAMINATE OPTION - GRADE B LWILSONARTBW:WILSONART GRADE B WOODGRAIN LAMINATES RO-L0168:LAMINATE - MONTICELLO MAPLE - (B-H-W-W-7925-		
102	1.00	Cb Desk Shell 3/4 Mod Recessed 30dx66wx29h EDGE:2MM GRADE A RO-E029-V2:EDGE DETAIL 2MM BLACK RIGID SMOOTH EDGE:2MM T-MOLD EDGE - GRADE A - CURVED EDGING RW-GRCB:B - REAR CENTER - LOCATION 1 (DEFAULT) GROMMETC:GROMMET COVER COLOR SELECTION W-GRC3B:GROMMET COVER - BLACK LAMAISA:AIS GRADE B LAMINATES LAMAISAW:AIS GRADE B WOODGRAIN LAMINATES RO-L0168:LAMINATE - MONTICELLO MAPLE - (B-H-W-W-7925-	\$401.53	\$401.53
103	1.00	"Pedestal Box/Box/File Mobile Lseries Laminated 24""D" PAINTMXP7:Paint Choice for Pedestals PAINTHAP2-15:Grade A Paint - Mobile Pedestals R0-P0002:BK-Black EDGE:2mm Grade A RO-E029-V2:EDGE DETAIL 2MM BLACK RIGID SMOOTH LAMAISA:AIS GRADE B LAMINATES LAMAISAW:AIS GRADE B WOODGRAIN LAMINATES RO-L0168:Laminate - Monticello Maple - (B-H-W-W-7925-	\$460.90	\$460.90
104	3.00	HANDLE L PULL PAINTED BLACK	\$7.34	\$22.02
105	1.00	Key Alike Kit (1 Core) - Wesko Type	\$5.34	\$5.34
106	1.00	Tbl, Rec, 2mm, 30dx72wx29h, Sqr, Gld EDGE:2mm Grade A RO-E029-V2:EDGE DETAIL 2MM BLACK RIGID SMOOTH	\$536.94	\$536.94

RW-GRRA:Option A - No additional grommets
 LAMTABB:TABLES GRADE B LAMINATES
 LAMAISA:AIS GRADE B LAMINATES
 LAMAISAW:AIS GRADE B WOODGRAIN LAMINATES
 RO-L0168:Laminate - Monticello Maple - (B-H-W-W-7925-
 PAINTSQP-A001:TABLE LEG GRADE A PAINT SELECTION
 RO-P0002:BK - Black

107	1.00	Tbl, Sqr, 2mm, 24dx29h, Stlx24, Gld EDGE:2mm Grade A RO-E029-V2:EDGE DETAIL 2MM BLACK RIGID SMOOTH LAMTABB:TABLES GRADE B LAMINATES LAMAISA:AIS GRADE B LAMINATES LAMAISAW:AIS GRADE B WOODGRAIN LAMINATES RO-L0168:Laminate - Monticello Maple - (B-H-W-W-7925- PAINTSB-A001:Grade A Paint For Steel Bases RO-P0002:BK - Black	\$234.45	\$234.45
108	1.00	Lateral File L Series Sq. Front 4 Drawer 30" PAINTHA-15:Paint Grade A RO-P0002:BK - Black	\$790.40	\$790.40
109	4.00	HANDLE L PULL PAINTED BLACK	\$7.34	\$29.36
110	1.00	Key Alike Kit (1 Core) - Wesko Type	\$5.34	\$5.34
111	1.00	Bookcase - 66H x 36W x 13 3/8D PAINTHA-15:Paint Grade A RO-P0002:BK - Black	\$580.62	\$580.62
112	2.00	Bolton Black Mid Back Configurable CP-CHAIR-ASSY:ASSEMBLED CP-4471-BMBACK:BLACK FRAME/BLACK SOLID MESH BACK STANDARD CP-4DARM:BLACK 4D ARM - PAIR CP-BASEB:CHAIR BASE - BLACK CP-60MMHARD:HARD CASTERS FOR CARPET STANDARD - SET OF 5 CP-3CYLINDER:4" CYLINDER - STANDARD CP-NONE:CAL 117 STANDARD CP-MECHSLS:MECHANISM CENTER TENSION SYNCHRO with SEAT S CP-49SEATBLACK:BLACK UPHOLSTERY STANDARD	\$427.49	\$854.98
113	2.00	Bolton Lumbar Support	\$23.46	\$46.92
114	11.00	Maari Sled Base, Poly Seat, Poly Back, No Arm, Plastic Glide Seat 1 Color:,TR-1V:INDIGO GRD A Frame Color:,TR-F:BLACK GRD A	\$200.18	\$2,201.98

Group	Extended
06 Misc	\$15,839.59

Line	Qty	Product	Unit	Extended
115	7.00	TBL, REC, 2mm, 30Dx72Wx29H, FLIP, CSTR,Metallic Silver Base Std EDGE:2mm Grade A RO-E029-V2:EDGE DETAIL 2MM BLACK RIGID SMOOTH LAMAISA:AIS GRADE B LAMINATES LAMAISAW:AIS GRADE B WOODGRAIN LAMINATES RO-L0168:Laminate - Monticello Maple - (B-H-W-W-7925-	\$912.79	\$6,389.53
116	2.00	Norix Max-Master Tables; 4 Seat Round; Molded Edge TOP:TITANIUM EVOLVE GAME TOP BASE:BLACK SEATS:LAGOON ACCESSORY:BOLT-DOWN	\$1,198.59	\$2,397.18
117	16.00	Maari Sled Base, Poly Seat, Poly Back, No Arm, Plastic Glide Seat 1 Color:,TR-1V:INDIGO GRD A Frame Color:,TR-F:BLACK GRD A	\$200.18	\$3,202.88
118	50.00	3" Grommet	\$77.00	\$3,850.00

Group	Extended
07 Freight and Surcharges	\$3,594.72

Line	Qty	Product	Unit	Extended
119	1.00	Agati Estimated Freight	\$2,960.00	\$2,960.00
120	1.00	AIS Estimated Surcharge	\$0.00	\$0.00
121	1.00	AIS Estimated Freight	\$0.00	\$0.00
122	1.00	Byrne Estimated Freight	\$17.00	\$17.00
123	1.00	Global Estimated Freight	\$30.00	\$30.00
124	1.00	Global Estimated Surcharge	\$23.40	\$23.40
125	1.00	Haworth Estimated Freight	\$0.00	\$0.00
126	1.00	Haworth Logistics Surcharge, to be billed at actual	\$270.32	\$270.32
127	1.00	Norix Estimated Freight	\$169.00	\$169.00
128	1.00	Surface Works Estimated Freight	\$0.00	\$0.00
129	1.00	Surface Works Estimated Surcharge	\$125.00	\$125.00

Group				Extended
08 Labor				\$6,765.00
Line	Qty	Product	Unit	Extended
131	1.00	<p>Labor to receive, deliver, assemble and install the following during straight time (M-F, 7am-4pm). (Union labor). Single phase. Per contract price of delivery and installation included in sell price. No stair carry. Dock available.</p> <p>Does not include in-feed hook up to main power source. Does not include any low voltage data wires.</p> <p>Does not include any permit fees if required.</p>	\$0.00	\$0.00
132	1.00	<p>Labor to receive, deliver, assemble and install the following during straight time (M-F, 7am-4pm). (Union labor). Single phase. Per contract, delivery and installation price separately from product sell price. No stair carry. Dock available.</p> <p>Does not include in-feed hook up to main power source. Does not include any low voltage data wires.</p> <p>Does not include any permit fees if required.</p>	\$6,765.00	\$6,765.00

Proposal

Total Product :	\$146,347.54
Total Freight :	\$3,594.72
Total Labor :	\$6,765.00

Order Sub-Total :	\$156,707.26
-------------------	--------------

Project Total :	\$156,707.26
------------------------	---------------------

Thank you for allowing BOS the opportunity to present pricing. If you should have any questions, please contact me at julie.kominsky@bos.com or 630-784-7745.

Sincerely,

Julie Kominsky

BOS Holdings and Affiliated Companies*

TERMS AND CONDITIONS OF SALE

By signing this proposal, Customer, hereinafter referred to as "Purchaser" agrees to the following terms and conditions:

1. **SCOPE:** Unless otherwise agreed in writing by the parties, these Terms and Conditions will apply to all purchases of office furniture, equipment and related services ("the Merchandise") from one or more of the companies listed above) hereinafter referred to as "Dealer") by Purchaser. The quotation/purchase order from Purchaser (once accepted in writing by) and all exhibits thereto will, together with these Terms and Conditions, constitute the "Agreement."
2. **GRANT OF SECURITY INTEREST:** To secure the performance of Purchaser's obligations under the Agreement, including all payment obligations, Purchaser hereby grants Dealer a security interest in the Merchandise. Purchaser agrees that Dealer may prepare and file a UCC financing statement and other instruments necessary to perfect, maintain, defend and enforce its security interest. Purchaser will sign such documents and take such other actions as Dealer may reasonably request to perfect, maintain, defend and enforce its security interest.
3. **CREDIT/PAYMENT TERMS:**
 - a. Credit. This Agreement is subject to credit approval. Credit may be established upon acceptance of satisfactory credit information, including a completed credit application. In the absence of adequate credit, full or partial payment at the time of ordering and/or payment upon delivery will be required.
 - b. Payment Terms. The terms of sale are as indicated on the invoice. All quotes are valid for up to 15 days. All payments will be made in U.S. dollars. Dealer will submit invoices as items are delivered or at the time of order completion. A monthly service charge of 1.5% per month (18% per annum) will be charged on all amounts not paid by Purchaser within fifteen (15) days of the invoice date and will be added to the balance outstanding.
 - c. Deposits. All required deposits must be received prior to the entering of any order. Dealer will apply deposits received pro rata to outstanding invoices. No interest shall accrue against such deposit. Required deposit amount is 50% of the contract amount less the amount required by manufacturers. Additionally, Purchaser shall supply any deposits required by manufacturers.
 - d. Withholding. Purchaser may withhold payment on an invoice only for damaged or non-conforming items of the Merchandise and only to the extent that such damage or failure to conform was expressly noted at the time of delivery, in writing, in accordance with Section 8(e) below. Such withholding shall in no way limit or impair Dealer's right to receive payment in full for all remaining items.
 - e. Credit Cards. Purchaser agrees to pay a convenience fee of 3% of the amount paid via credit card.
4. **ADDITIONAL COSTS**
 - a. Taxes. Purchaser shall pay all taxes, duties and tariffs applicable to any purchase or sale of the Merchandise. If Purchaser claims exemption from the payment of sales tax (or any similar tax that may be applicable to a purchase Purchaser will provide a completed certificate of resale or tax-exempt certificate upon Dealer's acceptance of a sale quotation or purchase order.
 - b. Storage:
 - i. Warehouse Shipments. Merchandise delivered via Dealer's warehouse, subject to space availability, may be held in its warehouse at the Purchaser's request at no charge for thirty (30) days. Storage charges will be invoiced for merchandise stored beyond the initial 30-day period.
 - ii. Direct Shipments. When merchandise is shipped directly to Purchaser from the manufacturer, Dealer will coordinate shipments to arrive at the jobsite at a reasonable time prior to the scheduled installation date. Purchaser shall make all necessary arrangements with landlords, other contractors, and other persons that Dealer can deliver the Merchandise to the jobsite without delay or disturbance. If Dealer is prevented from delivering the merchandise to the jobsite as a result of any cause or event beyond the control of Dealer, the merchandise will be rerouted to another suitable location. Purchaser will pay all additional costs associated with such rerouting, including transportation, handling, and storage charges.
5. **DISCLAIMER OF WARRANTIES:** DEALER HEREBY DISCLAIMS AND EXCLUDES ALL WARRANTIES EXPRESS OR IMPLIED, INCLUDING THE IMPLIED WARRANTY OF MERCHANTABILITY AND FITNESS FOR A PARTICULAR PURPOSE. All new product warranties come solely from the manufacturer. Dealer provides no warranties unless otherwise stated. All used furniture is sold "as is" without any manufacturer or dealer warranties whatsoever.
6. **CANCELLATION/RETURN/CHANGES/ADDITIONS:** All sales are final. No additions, substitutions or cancellations of any order, and no modifications or amendment of these Terms and Conditions shall be effective unless signed by duly authorized officers of Purchaser and Dealer.
7. **JOBSITE CONDITIONS**
 - a. Jobsite Services. Reasonable electric current, light, heat, hoisting and elevator service and reasonable access to suitable unobstructed dock space, trash disposal facilities, and secured staging/storage areas will be furnished by Purchaser without charge to Dealer.
 - b. Condition of Jobsite. Purchaser's jobsite shall be clean, clear, and free of debris prior to installation. Delivery and installation encumbrances that necessitate additional labor will result in extra charges. The jobsite shall also be free of interference and all trades in the work areas, and if jobsite is not free of such trade interference, the delivery and installation shall not proceed until such interference has been eliminated, or other arrangements are agreed to in writing. Subject to these conditions, Dealer shall be held harmless and shall not assume liability for job delay.
 - c. Permits, Dock, Elevator Fees, etc.. Purchaser agrees to pay for the cost of village permits, license fees, dock fees, scaffolding and other required items if not otherwise stated in the proposal.
8. **DELIVERY/INSTALLATION**
 - a. Title. Title to the Merchandise will pass to Purchaser upon delivery to the "Ship To" address specified in the Agreement.
 - b. Working Hours. Delivery and installation will be made during normal working hours, unless otherwise agreed in writing. The Purchaser will pay additional labor costs resulting from overtime work performed at the Purchaser's request, at the applicable overtime rate.
 - c. Responsibilities. Dealer may elect to meet direct trailer shipments at the jobsite and install without rehandling.
 - d. Erection and Assembly. If trade regulations in force at the time of installation require employing on-site tradesmen to complete the installation, the labor cost differential will be additionally invoiced to the Purchaser.
 - e. Receipt and Protection of Delivered Goods. Purchaser will inspect and accept the Merchandise immediately upon pickup or delivery, subject to any exceptions for damaged or non-conforming items as noted in writing at that time. If Dealer received notice in accordance with the preceding sentence, it will take all reasonable steps to replace damaged or non-conforming items of Merchandise. After delivery, all risk of loss or damage to the items, including insurance, shall be borne by the Purchaser, and destruction or loss of or damage to the Merchandise shall not affect the obligation of the Purchasers to pay for same.

9. **LIMITATION ON CLAIMS**

a. Claims. Any action by the Purchaser for breach or enforcement of the Agreement must be filed within one (1) year of the time such cause of action arises, after which time the Purchaser shall be forever barred from bringing such action.

10. **GENERAL**

a. Assignment. Purchaser may not transfer or assign any of its rights or obligations under the Agreement without Dealer's prior written consent, which consent may be withheld by Dealer in its sole discretion. Any attempted transfer or assignment will be void. Any assignee of Dealer shall be entitled to all its rights under the Agreement.

b. Force Majeure. Dealer shall not be liable for any conditions resulting from any strike, lockout, work stoppage, accident, act of God, manufacturer or carrier's delay, or other delay beyond its control.

c. Costs. Purchaser shall be responsible for any costs including legal fees incurred by Dealer in connection with the enforcement of the Agreement or the collection of Purchaser's account.

d. Terms and Conditions Controlling. These Terms and Conditions are an essential part of the Agreement. Except as provided in the following sentence, these Terms and Conditions supersede all terms and conditions appearing on Purchaser's purchase order or any other document and all oral communications and understandings relating to the sale, rental or purchase of the Merchandise. To the extent, if any, that these Terms and Conditions are inconsistent with any provision or provisions of an existing agreement between dealer and Purchaser or a tripartite agreement among Purchaser, Dealer and a manufacturer, the latter agreement will control.

e. Governing Law and Authority. This Agreement will be construed and enforced under the laws of the States of Illinois, Wisconsin or Florida depending on the BOS* dealership. The party signing below represents to have the corporate authority to bind the Purchaser to the terms of this agreement

*BOS Holdings and affiliated companies

Operating Company	Address	City	State	Zip	Legal entity	FEIN
BOS Holdings	501 S. Gary Avenue	Roselle	IL	60172	BOS Holdings, Inc.	20-1751342
BOS of Illinois	501 S. Gary Avenue	Roselle	IL	60172	BOS of Illinois, Inc.	36-4060500
AOI of Madison	1954 S. Stoughton Rd.	Madison	WI	53716	Affordable Office Interiors, LLC	20-1763709
BOS of Orlando	200 Technology Park	Lake Mary	FL	32746	BOS of Florida, Inc.	47-5547423
BOS of Tampa	1600 E. Eighth Avenue	Tampa	FL	33605	BOS of Florida, Inc.	47-5547423
Workspace Digital	501 S. Gary Avenue	Roselle	IL	60172	BOS of Illinois, Inc.	36-4060500

Agreed to:

Lake County Juvenile Depke / \$156,707.26 / 44199 / 01/10/2022

Purchaser / Project Total / CORE Proposal Number / Date Proposal Issued

Purchaser

Signature / Title

Printed Name / Date

ESTIMATED LEADTIMES

Customer Initials

AGATI	10-12 WEEKS PLUS TRANSIT TIME
AIS	11-12 WEEKS PLUS TRANSIT TIME
BYRNE	3-4 WEEKS PLUS TRANSIT TIME
GLOBAL	6-7 WEEKS PLUS TRANSIT TIME
HAWORTH	4-5 WEEKS PLUS TRANSIT TIME
NORIX	8-10 WEEKS PLUS TRANSIT TIME
SURFACE WORKS	6-8 WEEKS PLUS TRANSIT TIME

*ALL LEADTIMES ARE SUBJECT TO CHANGE BASED ON MATERIAL SHORTAGES.

Carrel pricing will go through an increase Jan. 31st. This is the major component of your proposal. Pricing valid through Jan 31, 2022 then it will need to be revised.



THANK YOU

We look forward to earning
your business.

