

BENCHMARKS		
NO.	DESCRIPTION	ELEV.
BM1	PK NAIL	676.87
BM2	PK NAIL	678.21

PUD BULK AND DENSITY STANDARD TABLE

- Bulk and Density Standards
 - Street Yard Setback
 - 50 Feet for residences and accessory buildings
 - Rear Yard Setback
 - 0 Feet for block walls
 - Side Yard Setback
 - 20 Feet for accessory buildings and non-conforming residence
 - 10 Feet for caretaker's residence and maintenance shop
 - 0 Feet for block walls
 - Height
 - Perimeter walls surrounding the temporary stockpile area and recycled aggregate material area shall not exceed 12 feet in height.
 - 25 Feet build storage stockpiles and recycled aggregate storage area.
- Maximum Impervious Surface
 - 152,000 Sq. Ft. (3.49 AC-Ft)
- Maximum Floor Area
 - 99,200 Sq. Ft. (2.28 AC-Ft)

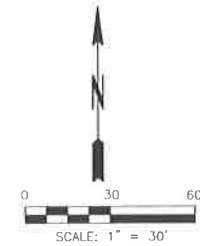

SITE LEGEND

- ASPHALT GRINDINGS
- CONCRETE PAVEMENT
- CONCRETE BLOCK WALL
- FLOOR AREA

PARKING REQUIREMENTS

2.5 PER 1000 S.F. FLOOR SPACE
 0.28 x 43,560 x 2.5 / 1000 = 30 PARKING SPACES
 26 CAR PARKING SPACES PROVIDED FOR 6 EMPLOYEES
 4 SEMI-TRUCK SPACES PROVIDED

AVERAGE NUMBER OF TRIPS PER DAY:

Summer: -25 trips
 Winter: -5 trips

SITE FLOOR AREA TABLE

MAINTENANCE SHOP	0.14 AC
BARN	0.02 AC
CARETAKER/OFFICE	0.06 AC
HOUSE	0.03 AC
GARAGE	0.03 AC
TOTAL	0.28 AC

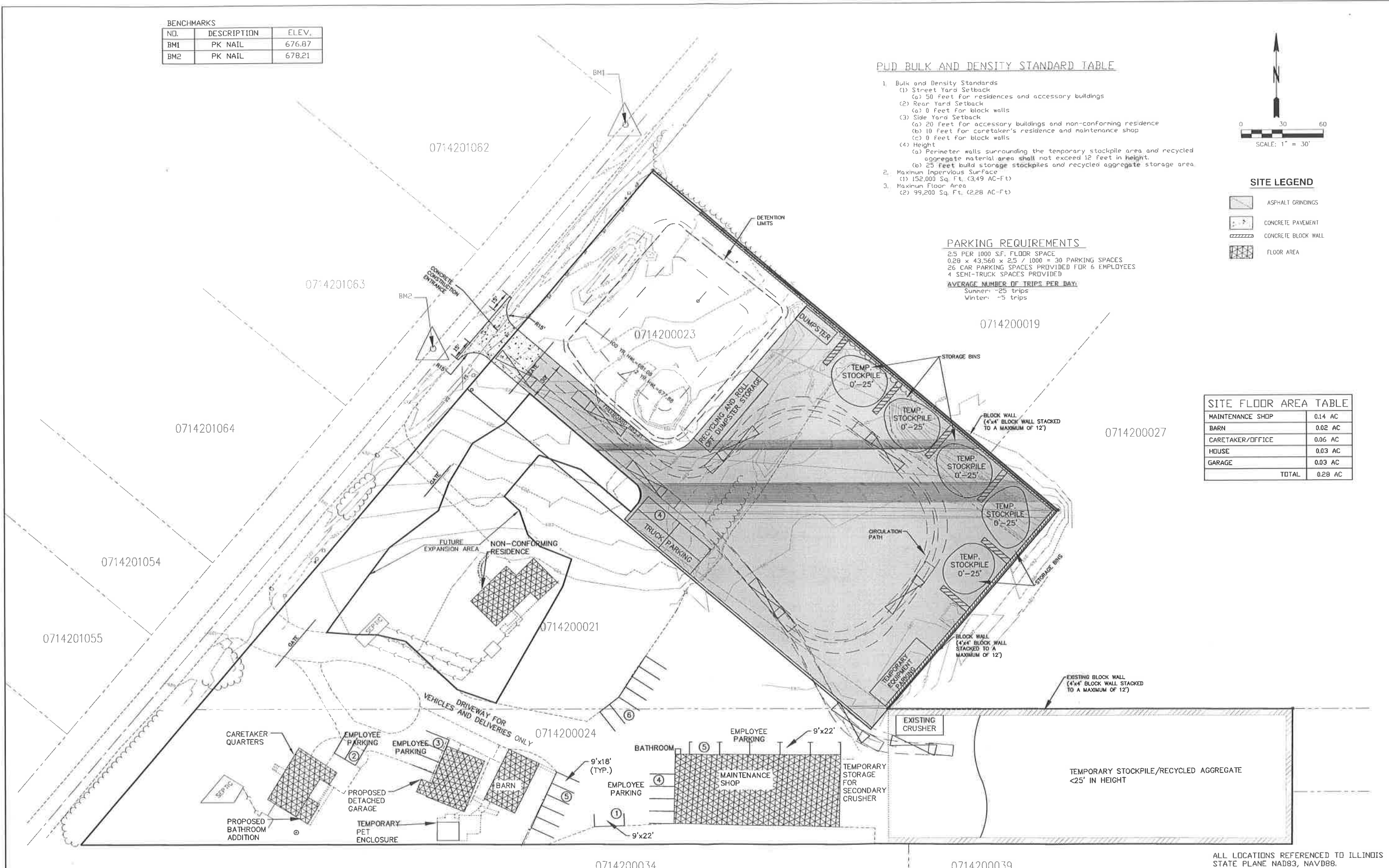

ALL LOCATIONS REFERENCED TO ILLINOIS STATE PLANE NAD83, NAVD88.

REVISIONS		
NO.	ITEM	DATE
1	PER LAKE COUNTY COMMENTS	10/14/14
2	PER LAKE COUNTY COMMENTS	12/8/14
3	PER LAKE COUNTY COMMENT LETTER DATED 1-5-2016	3/18/16
4	PER LAKE COUNTY COMMENT LETTER DATED 5-25-2016	7/1/16
5	PER OWNER	12/14/2016

REVISIONS		
NO.	ITEM	DATE
6	PER LAKE COUNTY COMMENTS DATED 01-17-2017	01/18/17
7	PRELIMINARY PUD	02/09/17
8	PUD FINAL PLAN	02/24/17

SCALE: 1" = 30'
 DRAWN BY: SFG
 CHECKED BY: HMD
 DATE: 02/24/17

McClure
 Engineering Associates, Inc.
 2728 Grand Avenue
 Waukegan, Illinois 60085-2495
 TEL 847-336-7100 FAX 847-336-7155
 Design Firm License: Illinois 184-000816
 Copyright 2014 by McClure Engineering Associates, Inc.

SITE PLAN
 PETERSEN EXCAVATING PLANNED UNIT DEVELOPMENT FINAL PLAN
 VILLAGE OF GURNEE JOB NUMBER: 02-14-14-129 LAKE COUNTY, ILLINOIS
 W:\dwg\GU\BARBERRY\14129BARBERRY_recover.dwg 2/23/2017 11:24 AM